

THIS DOCUMENT IS SUBJECT TO CHANGE WITHOUT NOTICE. IT IS CONFIDENTIAL AND A PROPERTY OF Amphenol LTW. DISCLOSURE TO THIRD PARTY HAS TO BE AUTHORIZED BY Amphenol LTW.

REV.	ECN NO.	DATE	SIGN	DESCRIPTION
A	Initial Release	2014-02-14	Fisher	Initial Release

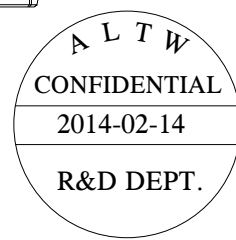
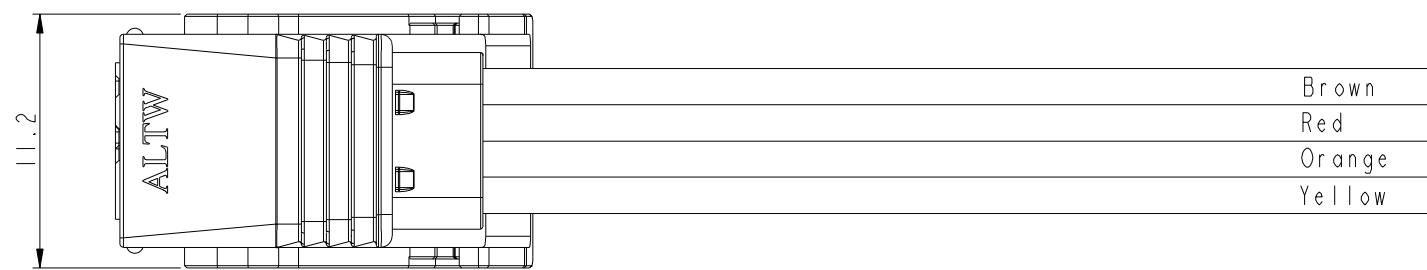
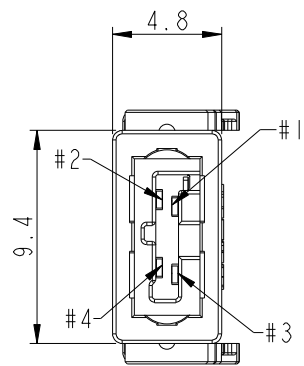
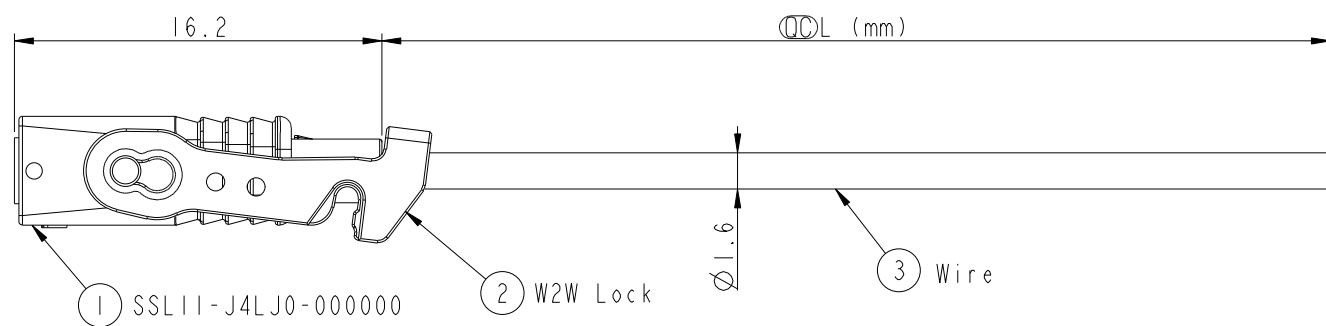

SSLII-J4LJ0-W22AXX

- 01: L=100±20 mm.
- 02: L=200±20 mm.
- 04: L=400±25 mm.
- Standard Length is 400mm
- Wire Length Range(L): 100~9900mm
- 22: 22AWG
- LOCK&LATCH OPTION
- W: WITH W2W LOCK

- Notes:
- * \varnothing Important Dimensions To Check.
 - * Housing: Thermoplastic, UL94V-0, Natural White.
 - * Terminal: Copper Alloy, Gold Plated.
 - * Hood: Thermoplastic, UL94V-0, Natural White.
 - * SR Mold: PP, UL94V-0, Natural White.
 - * W2W Lock: Thermoplastic, UL94V-0, Natural White.
 - * Wire: UL1430 22AWG, Brown/Red/Orange/Yellow/Green/Blue.
 - * Wire Length Tolerance: ±5%mm.

	4	Yellow	黃
B	3	Orange	橙
	2	Red	紅
	1	Brown	棕
	Conn. 1	Wire Color	
Pin Out			

UNIT:mm		TITLE
TOLERANCE		SSLII WIRE ASS'Y, WITH W2W LOCK
.X	±0.25	4-POS, JACK TO OPEN
.XX	±0.1	SCALE 3:1
.XXX	±0.05	SIZE A4
ANGLES	±1°	SHEET 1 OF 1
REV. A	WC-REV. A.2	QC: Inspection item

Amphenol LTW
安費諾亮泰企業股份有限公司

ITEM NO	DRAWN BY	DATE
DWG NO	SSLII-J4LJ0-W22AXX	Fisher_Wang
CUSTOMER	ALTW	Ivan_Lin
APPROVED BY	Kevin_Hu	2014-02-14