

THIS DOCUMENT IS SUBJECT TO CHANGE WITHOUT NOTICE. IT IS CONFIDENTIAL AND A PROPERTY OF Amphenol LTW. DISCLOSURE TO THIRD PARTY HAS TO BE AUTHORIZED BY Amphenol LTW.

REV.	ECN NO.	DATE	SIGN	DESCRIPTION
A		2020/01/17	Allen Pan	Rev.03 To Rev.A
B	C200150	2020/02/04	Allen Pan	$\triangle B$ X3
C	C220487	2022/04/18	Vicky	$\triangle C$ X3

$\triangle B$ AD-XXBMMB-QL8AP0
 $\triangle C$ XX: No. Of Pin

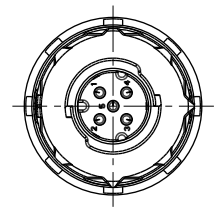
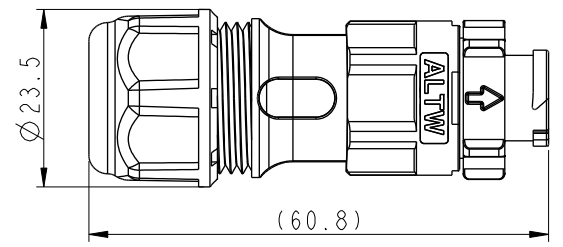
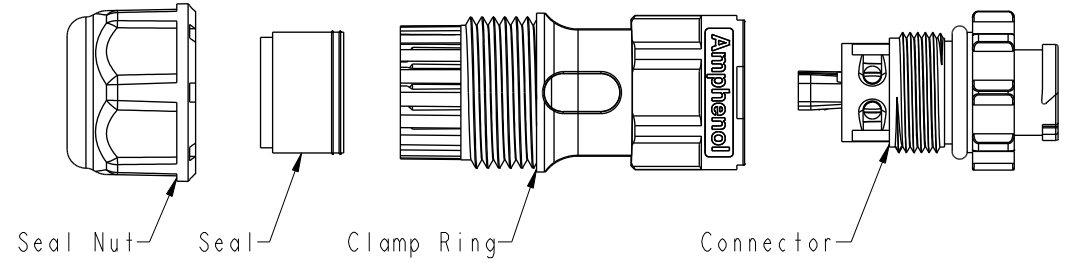

- $\triangle C$ Note:
- * RoHS Compliant
 - * Waterproof rate: IPX8, mated 1m/24h
 - * Connector
 Housing: Thermoplastic, Black
 Pin: Copper alloy, Gold plated
 O-Ring: Rubber, Dark gray
 - * Clamp Ring: Thermoplastic, Black
 - * Sealing Nut: Thermoplastic, Black
 - * Seal 1: Rubber, Red, OD: $\varnothing 4.0\text{mm} \sim \varnothing 6.0\text{mm}$
 - * Seal 2: Rubber, Blue, OD: $\varnothing 6.0\text{mm} \sim \varnothing 8.0\text{mm}$
 - * One set unassembled in one pe bag

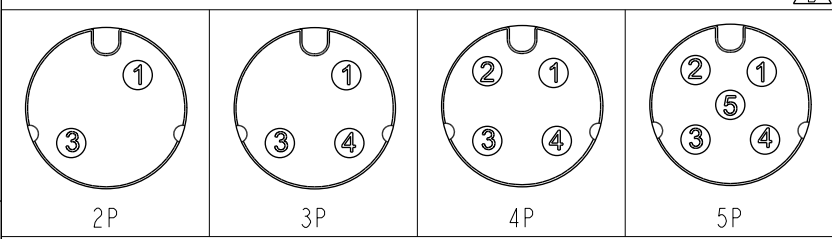

Pin Assignments Front View

UNIT:mm		TITLE	XLOK, A-5A, CABLE W/O SR M, M, FI SCREW IN, PUSH LOCK	$\triangle C$					
TOLERANCE	$\pm 0.5\text{mm}$	SCALE			1:1				
		SIZE			A4				
		REV.	C	WC-REV.	A.6	SHEET	1	OF	1
						QC: Inspection item			

Amphenol LTW
 安費諾亮泰企業股份有限公司

ITEM NO	DRAWN BY	DATE
	Allen Pan	2020-01-17
DWG NO	CHECKED BY	DATE
$\triangle B$ AD-XXBMMB-QL8AP0	Sam Ho	2020-01-17
CUSTOMER	APPROVED BY	DATE
ALTW	Fred Lee	2020-01-17