

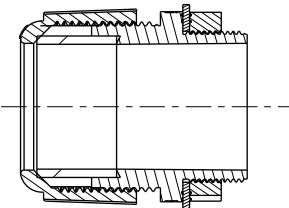

REV.	ECN NO.	DATE	SIGN	DESCRIPTION
B	LEN1570061	2015/06/02	Ruru	Change Logo

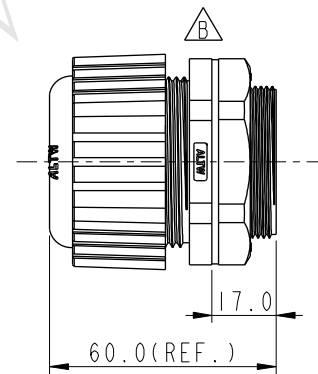

Section A-A

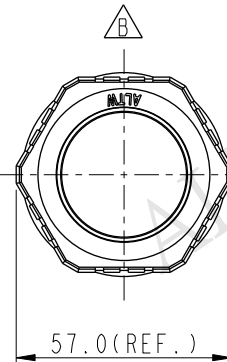
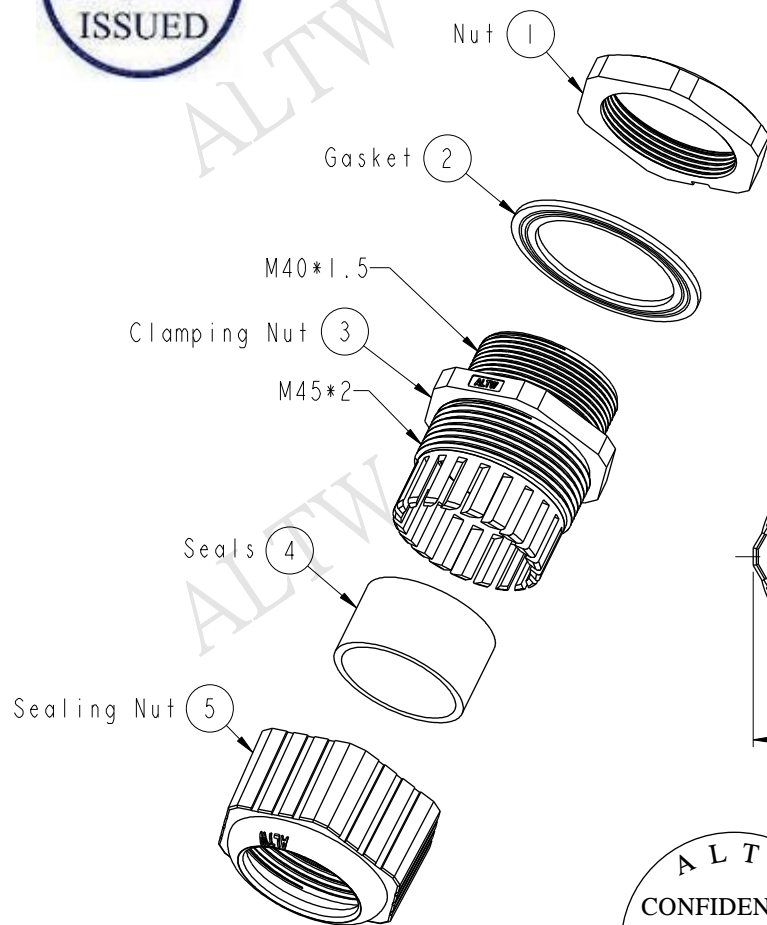
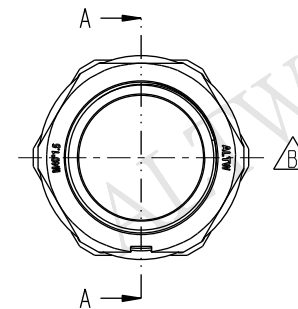

Note:

- * Waterproof Rate: IP68
- * Screw Nut: Nylon, Black
- * Clamp Ring: Nylon, Black
- * Sealing Nut: Nylon, Black
- * Gasket: EPDM, Black
- * Seals: EPDM, Black
- * For Panel Thickness: 9.0mm max
- * Cable Range: $\varnothing 24 \sim \varnothing 32$ mm
- * Spanner Size:
 - Body: 50.3mm
 - Sealing Nut: 51.7mm
 - Screw Nut: 50.0mm

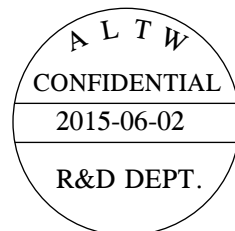

UNIT:mm		TITLE		ITEM NO		DRAWN BY		DATE	
TOLERANCE		Cable Gland Assembly(M40*1.5)		CSG-40M003		Ruru		2015-06-02	
± 0.5 mm		SCALE	SIZE	SHEET	OF	DWG NO	CHECKED BY	DATE	
		1:2	A4	1	1	CSG-40M003	Rita	2015-06-02	
		REV.	WC-REV.	QC: Inspection item		CUSTOMER	APPROVED BY	DATE	
		B	A.1			ALTW	Lion	2015-06-02	

Amphenol LTW
安費諾亮泰企業股份有限公司

THIS DOCUMENT IS SUBJECT TO CHANGE WITHOUT NOTICE. IT IS CONFIDENTIAL AND A PROPERTY OF Amphenol LTW. DISCLOSURE TO THIRD PARTY HAS TO BE AUTHORIZED BY Amphenol LTW.