

REV.	ECN NO.	DATE	SIGN	DESCRIPTION
B	LEN1510143	2015/01/06	Vicky	Update Logo & Dimension
C	LEN1560410	2015/05/29	Ruru	Change Logo

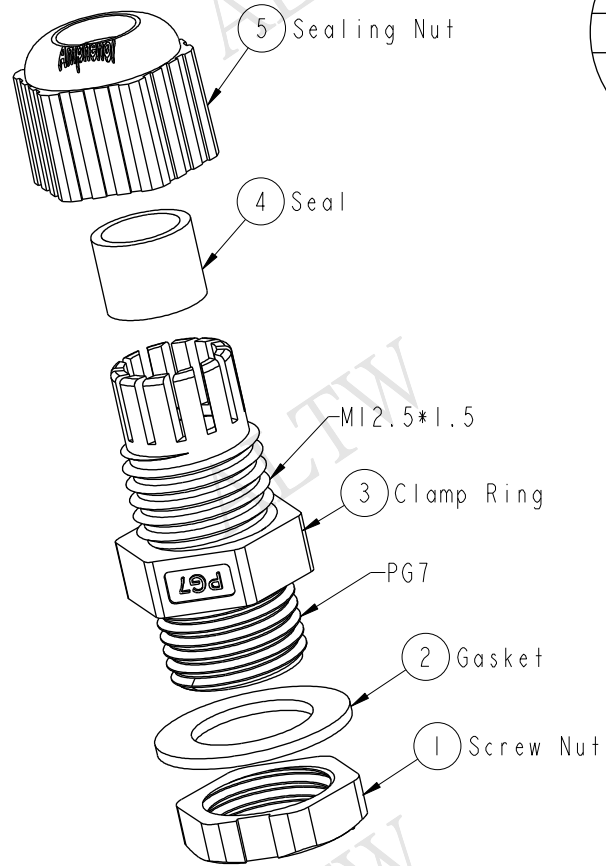

ALTW  
CONFIDENTIAL  
2015-05-29  
R&D DEPT.

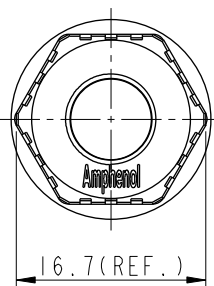

ALTW  
DCC. DEPT.  
CONFIDENTIAL  
2015.06.29  
ISSUED

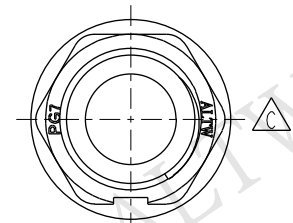
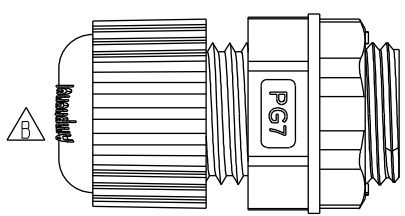
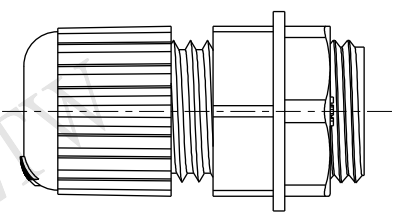
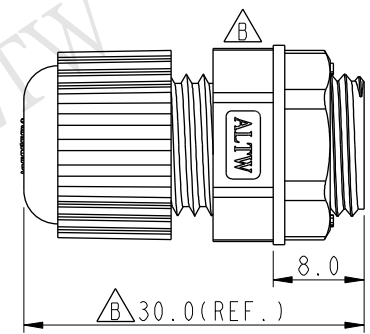

Note:  
\* Waterproof Rate: IP68  
IP68: 1M Depth Of Water In 24hours  
\* Screw Nut: Nylon, Gray  
\* Gasket: EPDM, Black  
\* Clamp Ring: Nylon, Gray  
\* Seal: EPDM, Black  
\* Sealing Nut: Nylon, Gray  
\* Cable Range:  $\varnothing 4.5\text{mm} \sim \varnothing 6.5\text{mm}$   
\* For Panel Thickness: 3.0mm Max.  
\* Spanner Size:  
Body: 15.0mm  
Sealing Nut: 15.0mm  
Screw Nut: 15.0mm

UNIT:mm		TOLERANCE		TITLE		PG7 Gland,Knock Hole		Amphenol LTW		ITEM NO		DRAWN BY		DATE	
$\pm 0.5 \text{ mm}$		SCALE		SIZE		SHEET		DWG NO		CSG-07G005		Ruru		2015-05-29	
		REV.		WC-REV.		QC		CUSTOMER		CSG-07G005		Rita		2015-05-29	
		C		A.3		Inspection item		ALTW				Lion		2015-05-29	

THIS DOCUMENT IS SUBJECT TO CHANGE WITHOUT NOTICE. IT IS CONFIDENTIAL AND A PROPERTY OF Amphenol LTW. DISCLOSURE TO THIRD PARTY HAS TO BE AUTHORIZED BY Amphenol LTW.