

| REV. | ECN NO. | DATE | SIGN | DESCRIPTION |
|------|----------------|------------|-------|----------------------|
| C | LEN-8C0092~95 | 2008/11/07 | TOMMY | Change to Pin Hole |
| D | LEN1610413~416 | 2016/01/13 | Ruru | Change Logo & Note |
| E | LEN1650427~430 | 2016/05/13 | Ruru | Modify Logo Position |

THIS DOCUMENT IS SUBJECT TO CHANGE WITHOUT NOTICE. IT IS CONFIDENTIAL AND A PROPERTY OF Amphenol LTW. DISCLOSURE TO THIRD PARTY HAS TO BE AUTHORIZED BY Amphenol LTW.

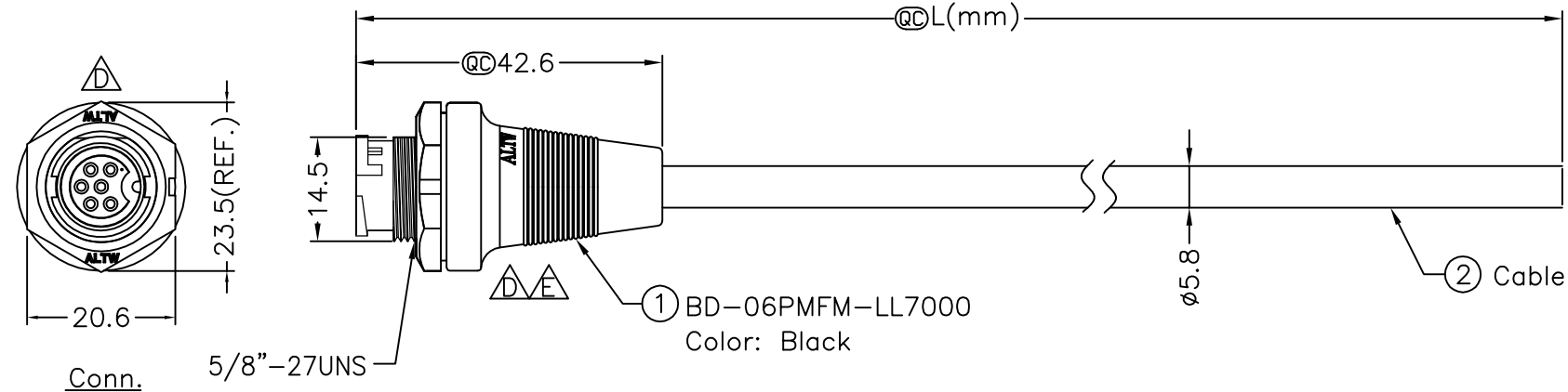

| | | |
|-------|------------|---|
| 6 | White | 白 |
| 5 | Red | 紅 |
| 4 | Orange | 橘 |
| 3 | Yellow | 黃 |
| 2 | Green | 綠 |
| 1 | Blue | 藍 |
| Conn. | Wire Color | |

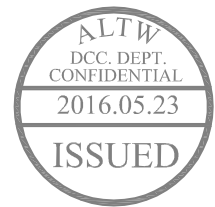

BD-06PMFM-LL7AXX

XX:01~99Meter
 01:01Meter
 02:02Meters
 ...
 99:99Meters

Cable Length(L):01~99Meters

- Note:
- * @C Important Dimensions To Check.
 - * Waterproof Rate: IP67
 - * Housing: Black,Nylon+GF
 - * Female Pin: Copper Alloy,Gold Plated
 - * Gasket: Black,EPDM
 - * Nut: Black,Nylon+GF
 - * Cable: UL2464 24AWG*6C+Drain+Al/My Black,PVC Jacket UV Resistant, OD=5.8
 - * Use with waterproof cap or dust cap
 Panel Thickness Max: 2.5mm
 - * Use without waterproof cap or dust cap
 Panel Thickness Max: 3.5mm
 - * Cable Length Tolerance: 01M: ±40mm
 02M~05M: ±60mm
 06M~10M: ±100mm
 11M~30M: ±200mm
 31M~99M: ±500mm

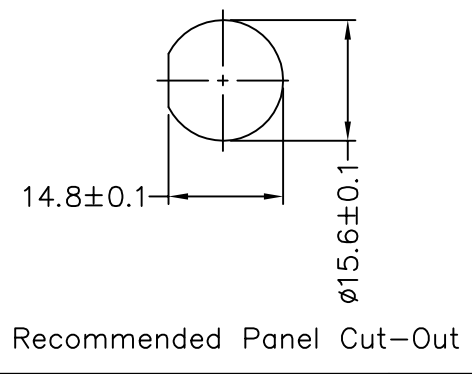
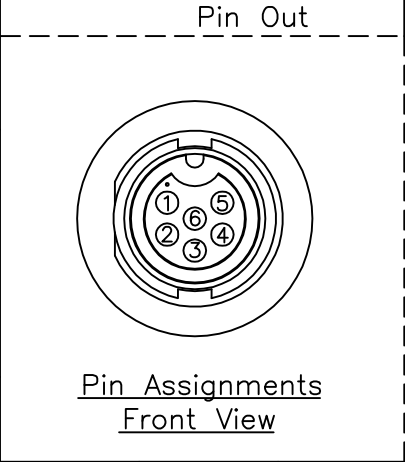

| | | |
|-----------|------|--|
| UNIT:mm | | TITLE |
| TOLERANCE | ±0.5 | Standard,Cable Lock 6Pin M Conn. F Pin |
| SCALE | Free | SHEET 1 OF 1 |
| REV. | E | SIZE A4 |
| | | @C :Inspection Item |

Amphenol LTW
 安費諾亮泰企業股份有限公司

| | | |
|------------------|-------------|------------|
| ITEM NO | DRAWN BY | DATE |
| DWG NO | CHECKED BY | DATE |
| CUSTOMER | APPROVED BY | DATE |
| | Ruru | 2016/05/13 |
| BD-06PMFM-LL7AXX | Rita | 2016/05/13 |
| ALTW | Lisa | 2016/05/13 |