

THIS DOCUMENT IS SUBJECT TO CHANGE WITHOUT NOTICE. IT IS CONFIDENTIAL AND A PROPERTY OF Amphenol LTW. DISCLOSURE TO THIRD PARTY HAS TO BE AUTHORIZED BY Amphenol LTW.

ALTW  
CONFIDENTIAL  
2017-04-17  
R&D DEPT.

REV.	ECN NO.	DATE	SIGN	DESCRIPTION
B	LEN1741188	2017/04/17	Ruru	Change Logo

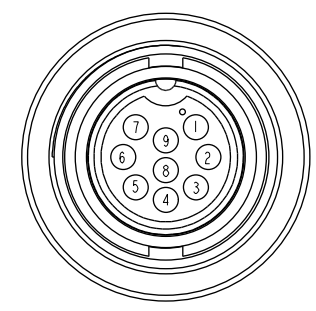
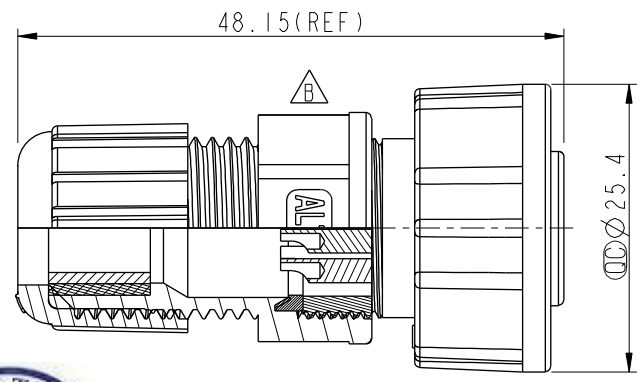
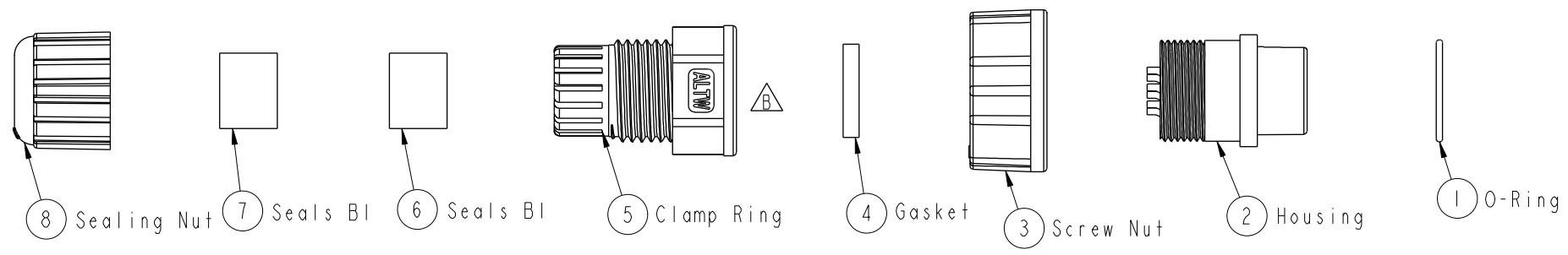

Pin Assignments  
Front View

- Note:
- \*  $\varnothing$  Important Dimension To Check.
  - \* Waterproof Rate: IP67
  - \* Housing: Nylon+GF, Black
  - \* Male Pin: Copper Alloy, Gold Plated
  - \* O-Ring: EPDM, Black
  - \* Screw Nut: Nylon+GF, Black
  - \* Gasket: EPDM, Black
  - \* Clamp Ring: Nylon, Black
  - \* Sealing Nut: Nylon, Black
  - \* Seals B1 for Cable OD:  $\varnothing 7.6\text{mm} \sim \varnothing 9.6\text{mm}$
  - \* Seals B2 for Cable OD:  $\varnothing 4.0\text{mm} \sim \varnothing 7.6\text{mm}$
  - \* One Set Unassembled in One PE Bag.

ALTW  
DCC. DEPT.  
CONFIDENTIAL  
2017.04.20  
ISSUED

UNIT:mm		TITLE Middle, Assy Lock 9Pin F Conn. M Pin		ITEM NO CD-09BFMA-SL7001		DRAWN BY Ruru		DATE 2017-04-17	
TOLERANCE .X $\pm 0.25$ .XX $\pm 0.1$ .XXX $\pm 0.05$ ANGLES $\pm 1^\circ$		SCALE 1:1	SIZE A4	SHEET 1	OF 1	DWG NO CD-09BFMA-SL7001		CHECKED BY Rita	
REV. B		WC-REV. A.2		$\varnothing$ Inspection item		CUSTOMER ALTW		APPROVED BY Max	
								DATE 2017-04-17	

Amphenol LTW  
安費諾亮泰企業股份有限公司