

5 Pin	PUR	4.4	22	LM12A-05BMMM-SR8BXX
4 Pin		4.0		LM12A-04BMMM-SR8BXX
3 Pin		3.8		LM12A-03BMMM-SR8BXX
Contacts	Cable Jacket	Cable OD	AWG	Item No.

REV.	ECN NO.	DATE	SIGN	DESCRIPTION
C	C211248	2021/05/07	Sam Ho	△C X1
D	C211529	2021/10/07	Sam Ho	△D X1
E	C221890	2022/12/28	Vicky	△E X2

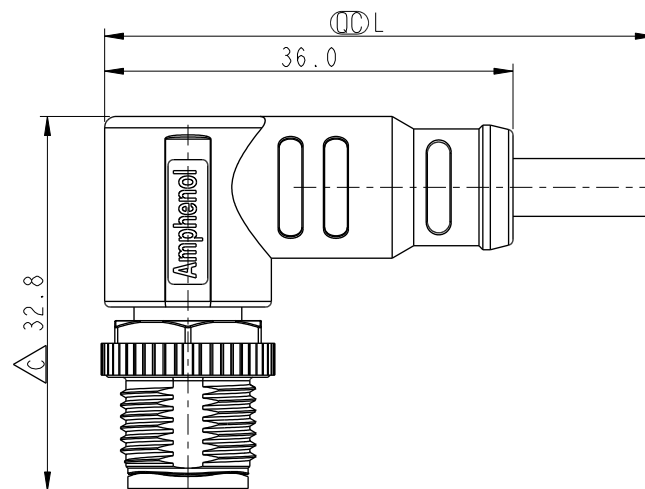
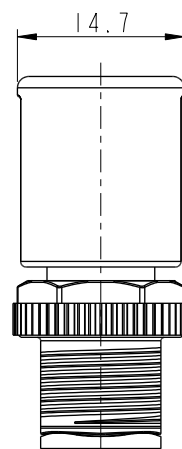
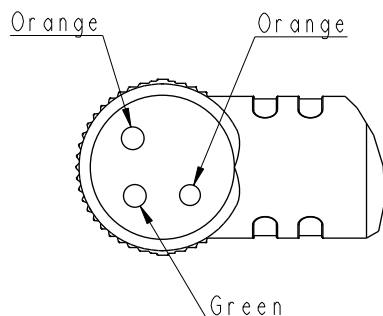
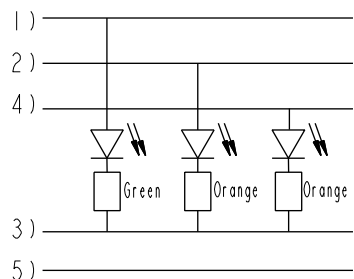

△D Note:

* (QC) Important dimension

△E * Waterproof rate: IP68, mated 1m/24h
IP69K, mated

* Connector

Housing: Thermoplastic, Black

Pin: Copper alloy, Gold plated

△B Nut: Metal

Outer Mold: Thermoplastic, Transparent Black.

* Cable: UL20549, PUR Jacket, Black

* Cable Length Tolerance:

1M: +50/-0 mm

1M < L ≤ 3M: +100/-0 mm

3M < L ≤ 5M: +150/-0 mm

5M < L ≤ 10M: ±100 mm

10M < L ≤ 20M: ±200 mm

20M < L ≤ 30M: ±300 mm

30M < L ≤ 99M: ±500 mm

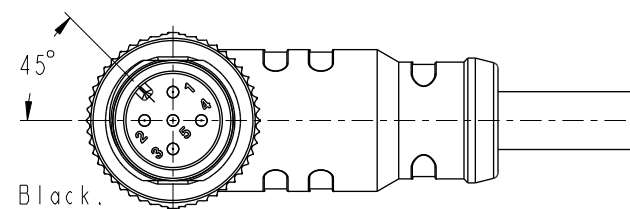
LM12A- XX BMMM-SR8B XX
No. Of PinXX: L=0~99Meters
01: L=1Meters
02: L=2Meters
:
99: L=99Meters

5	-	5	-	5	Gray	灰
4	Black	4	Black	4	Black	黑
3	Blue	3	Blue	3	Blue	藍
2	-	2	White	2	White	白
1	Brown	1	Brown	1	Brown	棕
Pin #	Wire	Pin #	Wire	Pin #	Wire	

Pin Out

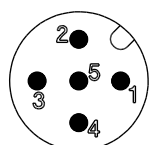
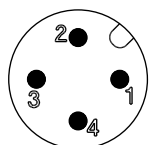
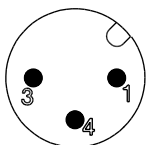

Pin Assignments Front View

UNIT:mm

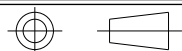

TOLERANCE

±0.50mm

TITLE
N SEN, M12 A-LED, SCREW
CABLE W/O SR, M, M, MOLDINGSCALE
3:2SIZE
A4SHEET
1 OF 1REV.
E

WC-REV.

(QC): Inspection item

Amphenol LTW
安費諾亮泰企業股份有限公司

ITEM NO.	DRAWN BY Sam Ho	DATE 2021-03-03
DWG NO. LM12A-XXBMMM-SR8BXX	CHECKED BY Fred Lee	DATE 2021-03-03
CUSTOMER ALTW	APPROVED BY Fred Lee	DATE 2021-03-03