

THIS DOCUMENT IS SUBJECT TO CHANGE WITHOUT NOTICE. IT IS CONFIDENTIAL AND A PROPERTY OF Amphenol LTW. DISCLOSURE TO THIRD PARTY HAS TO BE AUTHORIZED BY Amphenol LTW.

REV.	ECN NO.	DATE	SIGN	DESCRIPTION
F	C201439	2020/09/10	Ruru	△ <sub>F</sub> X5
G	C210220	2021/03/02	Vicky	△ <sub>G</sub> X4
H	C221891	2022/12/16	Vicky	△ <sub>H</sub> X1

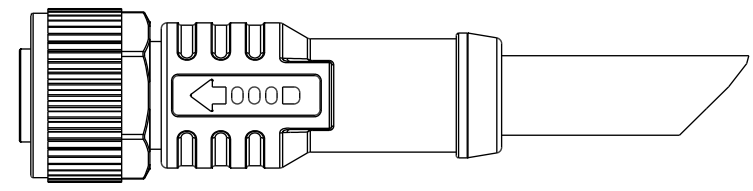
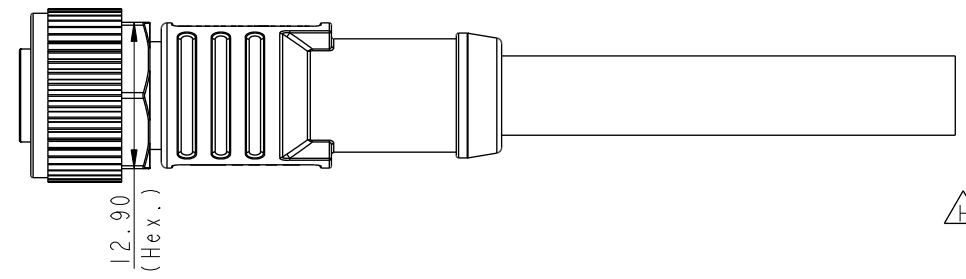
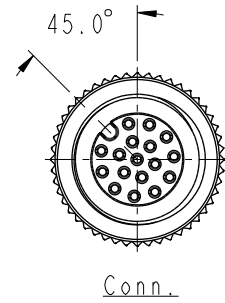
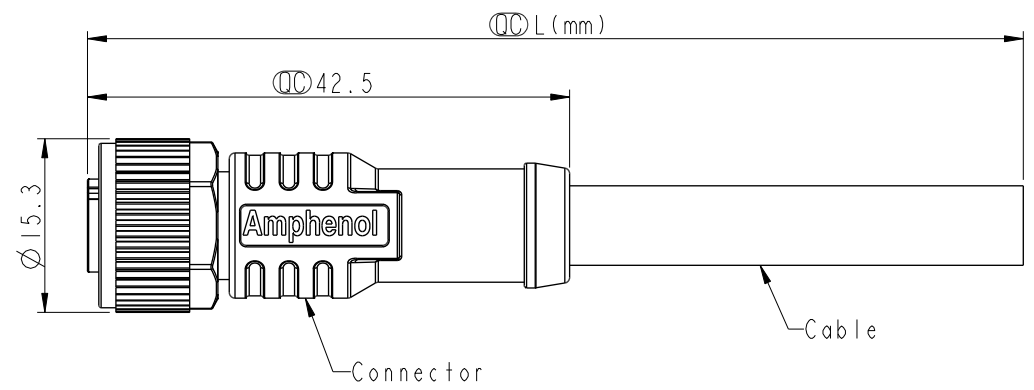

Note:  
 \* RoHS Compliant  
 \*  $\varnothing$  Important dimension  
 △ \* Waterproof rate: IP68, mated 1m/24h  
 IP69K, mated

- \* Connector
- Housing: Thermoplastic, Black
- Pin: Copper alloy, Gold plated
- O-Ring: Rubber, Green
- Nut: Metal
- Outer mold: Thermoplastic, Black
- \* Cable: UL20549, PUR Jacket, Black
- \* Cable length tolerance: 1M: +50/-0 mm
- 1M < L ≤ 3M: +100/-0 mm
- 3M < L ≤ 5M: +150/-0 mm
- 5M < L ≤ 10M: ±100 mm
- 10M < L ≤ 20M: ±200 mm
- 20M < L ≤ 30M: ±300 mm
- 30M < L ≤ 99M: ±500 mm

UNIT: mm   
 TOLERANCE  
 ±0.5mm

TITLE N SEN, M12 A, SCREW CABLE W/O SR, F, F, MOLDING			△ <sub>G</sub>
SCALE 3:2	SIZE A4	SHEET 1 OF 2	
REV. H	WC-REV. A.3	⊙: Inspection item	

**Amphenol LTW**  
 安費諾亮泰企業股份有限公司

ITEM NO	DRAWN BY Lingpeng	DATE 2017-04-06
DWG NO △ <sub>E</sub> M12A-XXBFFM-SL8BXX	CHECKED BY Ma Fei	DATE 2017-04-06
CUSTOMER ALTW	APPROVED BY Jerry	DATE 2017-04-06

THIS DOCUMENT IS SUBJECT TO CHANGE WITHOUT NOTICE. IT IS CONFIDENTIAL AND A PROPERTY OF Amphenol LTW. DISCLOSURE TO THIRD PARTY HAS TO BE AUTHORIZED BY Amphenol LTW.

F	<p>MI2A-XXBFFM-SL8BXX</p> <p>XX: No. Of Pin</p> <p>XX: 01~99Meters 01: 01Meter 02: 02Meters : 99: 99Meters</p>						8				
E							E	17P	7.0	26	M12A-17BFFM-SL8BXX
							12P	6.0	M12A-12BFFM-SL8BXX		
							10P		M12A-10BFFM-SL8BXX		
						C/D	8P	4.8	24	M12A-08BFFM-SL8BXX	
							6P	5.0		M12A-06BFFM-SL8BXX	
							5P	4.4		M12A-05BFFM-SL8BXX	
							4P	4.0	22	M12A-04BFFM-SL8BXX	
							3P	3.8		M12A-03BFFM-SL8BXX	
						F/G	Contacts	Cable OD	AWG		Item No.

C	Pin Out	5 -- 4 Black 黑 3 Blue 藍 2 -- 1 Brown 棕	5 -- 4 Black 黑 3 Blue 藍 2 White 白 1 Brown 棕	5 Gray 灰 4 Black 黑 3 Blue 藍 2 White 白 1 Brown 棕	8 -- 7 Blue 藍 6 Pink 粉 5 -- 4 Yellow 黃 3 Green 綠 2 Brown 棕 1 White 白	8 Red 紅 7 Blue 藍 6 Pink 粉 5 Gray 灰 4 Yellow 黃 3 Green 綠 2 Brown 棕 1 White 白	12 -- 11 -- 10 Violet 紫 9 Black 黑 8 Red 紅 7 Blue 藍 6 Pink 粉 5 Gray 灰 4 Yellow 黃 3 Green 綠 2 Brown 棕 1 White 白	12 Red/Blue 紅/藍 11 Gray/Pink 灰/粉 10 Violet 紫 9 Black 黑 8 Red 紅 7 Blue 藍 6 Pink 粉 5 Gray 灰 4 Yellow 黃 3 Green 綠 2 Brown 棕 1 White 白	17 White/Gray 白/灰 16 Yellow/Brown 黃/棕 15 White/Yellow 白/黃 14 Brown/Green 棕/綠 13 White/Green 白/綠 12 Red/Blue 紅/藍 11 Gray/Pink 灰/粉 10 Violet 紫 9 Red 紅 8 Gray 灰 7 Black 黑 6 Yellow 黃 5 Pink 粉 4 Green 綠 3 White 白 2 Blue 藍 1 Brown 棕	Pin # Wire	Pin # Wire
B	Conn.										

Pin Assignments Front View

UNIT:mm		TITLE N SEN, M12 A, SCREW CABLE W/O SR, F, F, MOLDING			ITEM NO	DRAWN BY Lingpeng	DATE 2017-04-06
TOLERANCE	±0.5mm	SCALE 3:2	SIZE A4	SHEET 2 OF 2	DWG NO MI2A-XXBFFM-SL8BXX	CHECKED BY Ma Fei	DATE 2017-04-06
		REV. H	WC-REV. A.2	QC: Inspection item	CUSTOMER ALTW	APPROVED BY Jerry	DATE 2017-04-06

**Amphenol LTW**  
安費諾亮泰企業股份有限公司