

THIS DOCUMENT IS SUBJECT TO CHANGE WITHOUT NOTICE. IT IS CONFIDENTIAL AND A PROPERTY OF AMPHENOL LTW. DISCLOSURE TO THIRD PARTY HAS TO BE AUTHORIZED BY AMPHENOL LTW.

REV.	ECN NO.	DATE	SIGN	DESCRIPTION
F	C201439	2020/09/10	Ruru	△F X5
G	C210220	2021/02/23	Vicky	△G X4
H	C221891	2022/12/16	Vicky	△H X1

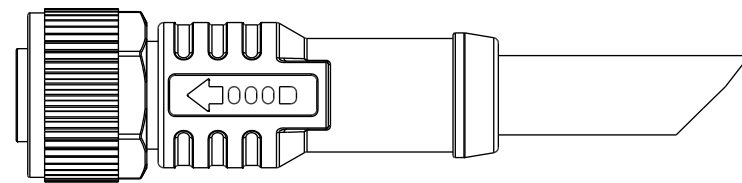
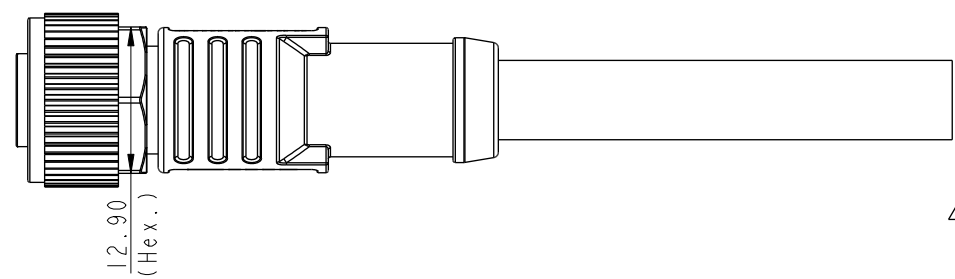
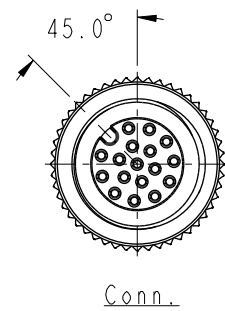
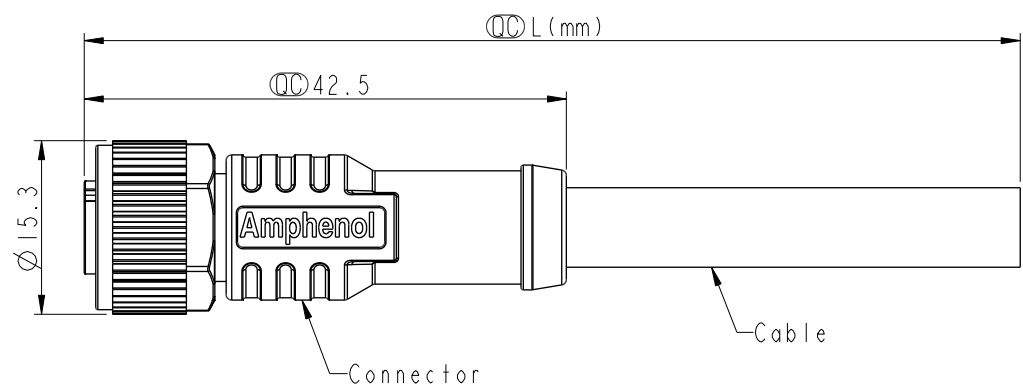

△C △E △F △G

Note:

- * RoHS Compliant
- * \varnothing Important dimension
- △A * Waterproof rate: IP68, mated 1m/24h
IP69K, mated

- * Connector
- Housing: Thermoplastic, Black
- Pin: Copper alloy, Gold plated
- O-Ring: Rubber, Green
- Nut: Metal
- Outer mold: Thermoplastic, Black
- * Cable: UL2517, PVC Jacket, Black
- * Cable length tolerance: 1M: +50/-0 mm

1M < L ≤ 3M	+100/-0 mm
3M < L ≤ 5M	+150/-0 mm
5M < L ≤ 10M	±100 mm
10M < L ≤ 20M	±200 mm
20M < L ≤ 30M	±300 mm
30M < L ≤ 99M	±500 mm

UNIT: mm		
TOLERANCE	±0.5mm	

TITLE N SEN, M12 A, SCREW CABLE W/O SR, F, F, MOLDING			△G
SCALE 3:2	SIZE A4	SHEET 1 OF 2	
REV. H	WC-REV. A.3	⊙: Inspection item	

Amphenol LTW
安費諾亮泰企業股份有限公司

ITEM NO	DRAWN BY Lingpeng	DATE 2017-04-06
DWG NO △E M12A-XXBFFM-SL8DXX	CHECKED BY Ma Fei	DATE 2017-04-06
CUSTOMER ALTW	APPROVED BY Jerry	DATE 2017-04-06

THIS DOCUMENT IS SUBJECT TO CHANGE WITHOUT NOTICE. IT IS CONFIDENTIAL AND A PROPERTY OF AMPHENOL LTW. DISCLOSURE TO THIRD PARTY HAS TO BE AUTHORIZED BY AMPHENOL LTW.

F	<p>M12A-XXBFFM-SL8DXX</p> <p>XX: No. Of Pin</p> <p>XX: 01~99Meters 01: 01Meter 02: 02Meters . 99: 99Meters</p>						8																																		
E							<table border="1" style="width: 100%; border-collapse: collapse;"> <tr> <td rowspan="3" style="text-align: center;">△E</td> <td>17P</td> <td>7.0</td> <td rowspan="3" style="text-align: center;">26</td> <td>M12A-17BFFM-SL8DXX</td> </tr> <tr> <td>12P</td> <td>6.0</td> <td>M12A-12BFFM-SL8DXX</td> </tr> <tr> <td>10P</td> <td></td> <td>M12A-10BFFM-SL8DXX</td> </tr> <tr> <td rowspan="3" style="text-align: center;">△C</td> <td>8P</td> <td>5.5</td> <td rowspan="3" style="text-align: center;">24</td> <td>M12A-08BFFM-SL8DXX</td> </tr> <tr> <td>6P</td> <td>5.0</td> <td>M12A-06BFFM-SL8DXX</td> </tr> <tr> <td>5P</td> <td>5.1</td> <td>M12A-05BFFM-SL8DXX</td> </tr> <tr> <td rowspan="3" style="text-align: center;">△F△G</td> <td>4P</td> <td>4.8</td> <td rowspan="3" style="text-align: center;">22</td> <td>M12A-04BFFM-SL8DXX</td> </tr> <tr> <td>3P</td> <td>4.5</td> <td>M12A-03BFFM-SL8DXX</td> </tr> <tr> <td>Contacts</td> <td>Cable OD</td> <td>AWG</td> <td>Item No.</td> </tr> </table>	△E	17P	7.0	26	M12A-17BFFM-SL8DXX	12P	6.0	M12A-12BFFM-SL8DXX	10P		M12A-10BFFM-SL8DXX	△C	8P	5.5	24	M12A-08BFFM-SL8DXX	6P	5.0	M12A-06BFFM-SL8DXX	5P	5.1	M12A-05BFFM-SL8DXX	△F△G	4P	4.8	22	M12A-04BFFM-SL8DXX	3P	4.5	M12A-03BFFM-SL8DXX	Contacts	Cable OD	AWG	Item No.
△E	17P	7.0	26	M12A-17BFFM-SL8DXX																																					
	12P	6.0		M12A-12BFFM-SL8DXX																																					
	10P			M12A-10BFFM-SL8DXX																																					
△C	8P	5.5	24	M12A-08BFFM-SL8DXX																																					
	6P	5.0		M12A-06BFFM-SL8DXX																																					
	5P	5.1		M12A-05BFFM-SL8DXX																																					
△F△G	4P	4.8	22	M12A-04BFFM-SL8DXX																																					
	3P	4.5		M12A-03BFFM-SL8DXX																																					
	Contacts	Cable OD		AWG	Item No.																																				

	Pin Out	5 -- 4 Black 黑 3 Blue 藍 2 -- 1 Brown 棕	5 -- 4 Black 黑 3 Blue 藍 2 White 白 1 Brown 棕	5 Gray 灰 4 Black 黑 3 Blue 藍 2 White 白 1 Brown 棕	8 -- 7 Blue 藍 6 Pink 粉 5 -- 4 Yellow 黃 3 Green 綠 2 Brown 棕 1 White 白	8 Red 紅 7 Blue 藍 6 Pink 粉 5 Gray 灰 4 Yellow 黃 3 Green 綠 2 Brown 棕 1 White 白	12 -- 11 -- 10 Violet 紫 9 Black 黑 8 Red 紅 7 Blue 藍 6 Pink 粉 5 Gray 灰 4 Yellow 黃 3 Green 綠 2 Brown 棕 1 White 白	12 Red/Blue 紅/藍 11 Gray/Pink 灰/粉 10 Violet 紫 9 Black 黑 8 Red 紅 7 Blue 藍 6 Pink 粉 5 Gray 灰 4 Yellow 黃 3 Green 綠 2 Brown 棕 1 White 白	17 White/Gray 白/灰 16 Yellow/Brown 黃/棕 15 White/Yellow 白/黃 14 Brown/Green 棕/綠 13 White/Green 白/綠 12 Red/Blue 紅/藍 11 Gray/Pink 灰/粉 10 Violet 紫 9 Red 紅 8 Gray 灰 7 Black 黑 6 Yellow 黃 5 Pink 粉 4 Green 綠 3 White 白 2 Blue 藍 1 Brown 棕
C		Pin # Wire	Pin # Wire	Pin # Wire	Pin # Wire	Pin # Wire	Pin # Wire	Pin # Wire	Pin # Wire
B	Conn.								

Pin Assignments Front View

UNIT:mm		TITLE N SEN, M12 A, SCREW CABLE W/O SR, F, F, MOLDING		Amphenol LTW	ITEM NO	DRAWN BY Lingpeng	DATE 2017-04-06
TOLERANCE	±0.5mm	SCALE 3:2	SIZE A4	安費諾亮泰企業股份有限公司	DWG NO △E M12A-XXBFFM-SL8DXX	CHECKED BY Ma Fei	DATE 2017-04-06
		REV. H	WC-REV. A.2	◎: Inspection item	CUSTOMER ALTW	APPROVED BY Jerry	DATE 2017-04-06