

THIS DOCUMENT IS SUBJECT TO CHANGE WITHOUT NOTICE. IT IS CONFIDENTIAL AND A PROPERTY OF Amphenol LTW. DISCLOSURE TO THIRD PARTY HAS TO BE AUTHORIZED BY Amphenol LTW.

REV.	ECN NO.	DATE	SIGN	DESCRIPTION
D	C210007	2020/12/29	Ruru	$\triangle D$ X5
E	C210561	2021/04/15	Vicky	$\triangle E$ X2
F	C221877	2022/12/09	Ruru	$\triangle F$ X1

$\triangle C$   $\triangle D$   
MSAS-XXBFFA-SL7001

XX: No. Of Pin

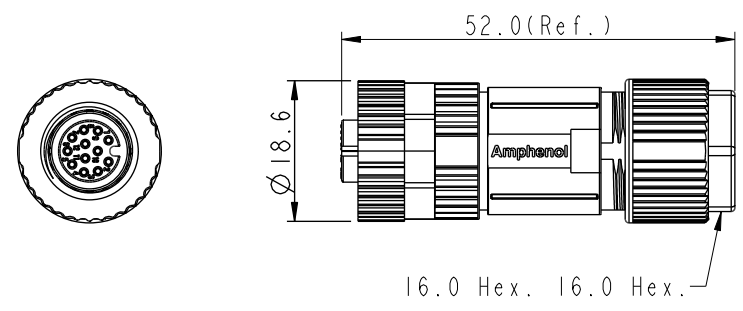
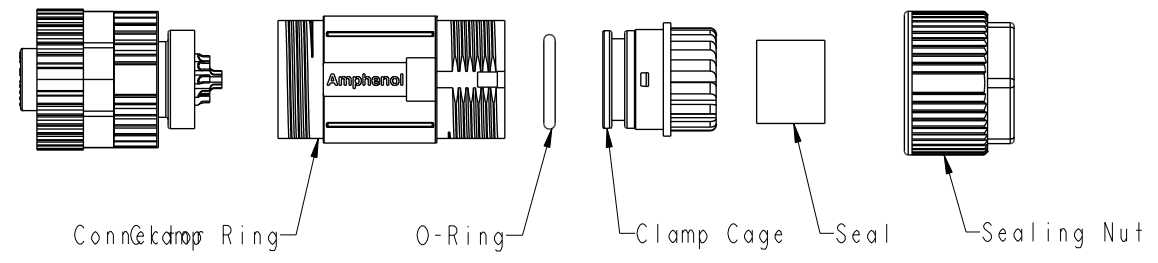

- $\triangle F$   
Note:
- \* RoHS Compliant
  - \*  $\odot$  Important Dimension
  - \*  $\triangle F$  \* Waterproof rate: IP67, mated Connector
  - Housing: Thermoplastic, Black
  - Pin: Copper alloy, Gold plated
  - Extension Nut: Metal
  - $\triangle D$  Nut: Metal
  - O-Ring: Rubber, Gray
  - $\triangle D$  \* Clamp Ring: Metal
  - \* O-Ring: Rubber, Gray
  - \* Clamp Cage: Thermoplastic, Black
  - $\triangle D$  \* Sealing Nut: Metal
  - \* Seal: Rubber, Gray, OD:  $\phi$ 4.0mm- $\phi$ 7.5mm
  - \* One set unassembled in one pe bag

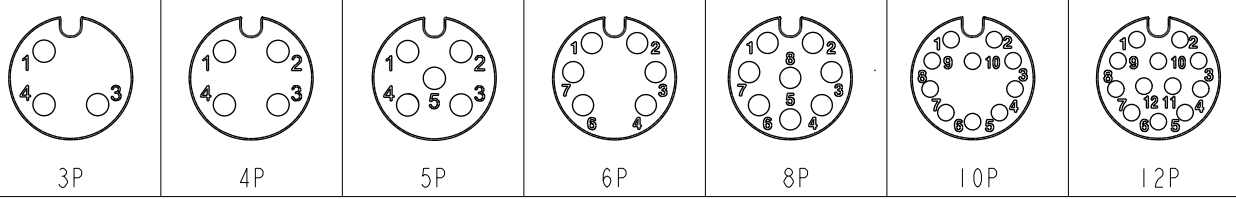

Pin Assignments Front View

UNIT: mm			TITLE			ITEM NO.	DRAWN BY	DATE
			N SEN, M12 A -SHLD, SCREW $\triangle D$ $\triangle E$ CABLE W/O SR, F, F, FI SOLDER			MSAS-XXBFFA-SL7001	Yulong_wang	2016-07-22
TOLERANCE			SCALE	SIZE	SHEET	CHECKED BY	DATE	
.X $\pm 0.25$			1:1	A4	1 OF 1	Jinhai	2016-07-22	
.XX $\pm 0.1$			REV.	WC-REV.		APPROVED BY	DATE	
.XXX $\pm 0.05$			F	.0	$\odot$ : Inspection item	Jerry	2016-07-22	
ANGLES $\pm 1^\circ$						CUSTOMER		
						ALTW		

**Amphenol LTW**  
安費諾亮泰企業股份有限公司