

THIS DOCUMENT IS SUBJECT TO CHANGE WITHOUT NOTICE. IT IS CONFIDENTIAL AND A PROPERTY OF Amphenol LTW. DISCLOSURE TO THIRD PARTY HAS TO BE AUTHORIZED BY Amphenol LTW.

REV.	ECN NO.	DATE	SIGN	DESCRIPTION
D	C201470	2020/10/05	Ruru	$\triangle D$ X4
E	C210211	2021/03/18	Ruru	$\triangle E$ X2
F	C221876	2022/12/06	Ruru	$\triangle F$ X1

$\triangle C$   $\triangle D$   
MSBP-XXBFFM-SL8BXX

XX: No. Of Pin

XX: 01~99Meters  
01: 01Meter  
02: 02Meters  
⋮  
99: 99Meters

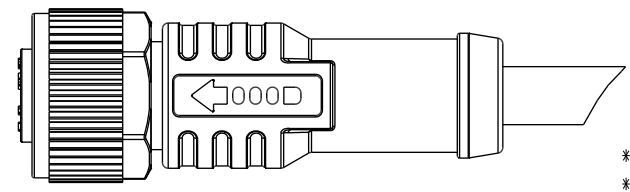
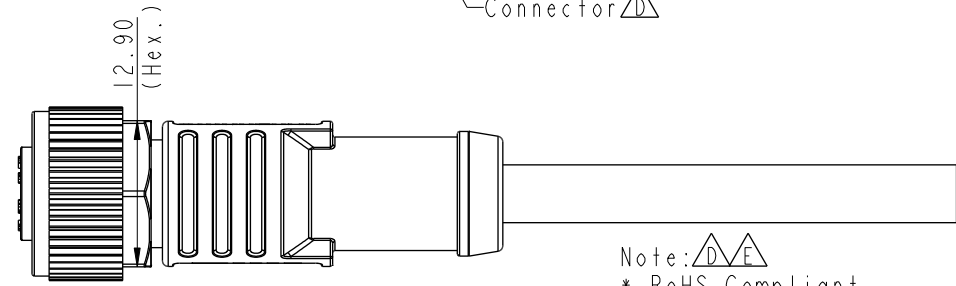
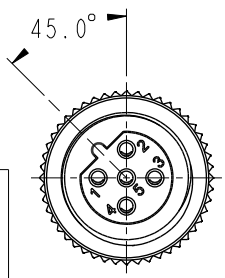
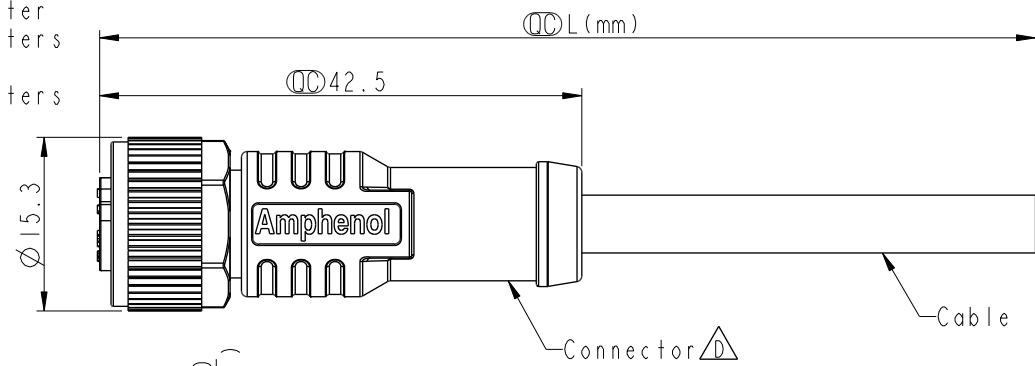

Pin Out	Color	Color
5	Gray	灰
4	Black	黑
3	Blue	藍
2	White	白
1	Brown	棕

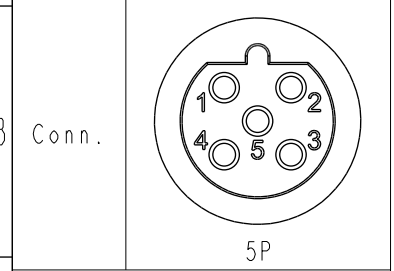

Pin Assignments Front View

Note:  $\triangle D$   $\triangle E$

- \* RoHS Compliant
- \*  $\text{\textcircled{C}}$  Important dimension
- \*  $\triangle F$   $\triangle C$  Waterproof rate: IP68, mated 1m/24h  
IP69K, mated
- \* Connector
  - Housing: Thermoplastic, Black
  - Pin: Copper alloy, Gold plated
  - O-Ring: Rubber, Green
  - Nut: Thermoplastic, Black
  - Outer mold: Thermoplastic, Black
- \* Cable: UL20549, 22#\*5C, OD=4.4mm, PUR Jacket, Black
- \* Cable length tolerance:
  - 1M < L ≤ 3M: +100/-0 mm
  - 3M < L ≤ 5M: +150/-0 mm
  - 5M < L ≤ 10M: ±100 mm
  - 10M < L ≤ 20M: ±200 mm
  - 20M < L ≤ 30M: ±300 mm
  - 30M < L ≤ 99M: ±500 mm

UNIT:mm	$\text{\textcircled{C}}$	$\text{\textcircled{D}}$
TOLERANCE	±0.5mm	

TITLE N SEN, M12 B -PLASTIC, SCREW CABLE W/O SR, F, F, MOLDING $\triangle E$			
SCALE 1:1	SIZE A4	SHEET 1 OF 1	
REV. F	WC-REV. A.2	$\text{\textcircled{C}}$ : Inspection item	

**Amphenol LTW**  
安費諾亮泰企業股份有限公司

ITEM NO	DRAWN BY Ruru	DATE 2019-01-21
DWG NO $\triangle D$ MSBP-XXBFFM-SL8BXX	CHECKED BY Rita	DATE 2019-01-21
CUSTOMER ALTW	APPROVED BY Max	DATE 2019-01-21