

THIS DOCUMENT IS SUBJECT TO CHANGE WITHOUT NOTICE. IT IS CONFIDENTIAL AND A PROPERTY OF Amphenol LTW. DISCLOSURE TO THIRD PARTY HAS TO BE AUTHORIZED BY Amphenol LTW.

REV.	ECN NO.	DATE	SIGN	DESCRIPTION
B	C201786	2020/11/17	Ruru	\triangle_B X3
C	C210237	2021/03/26	Ruru	\triangle_C X2
D	C230014	2022/12/30	Ruru	\triangle_D X2

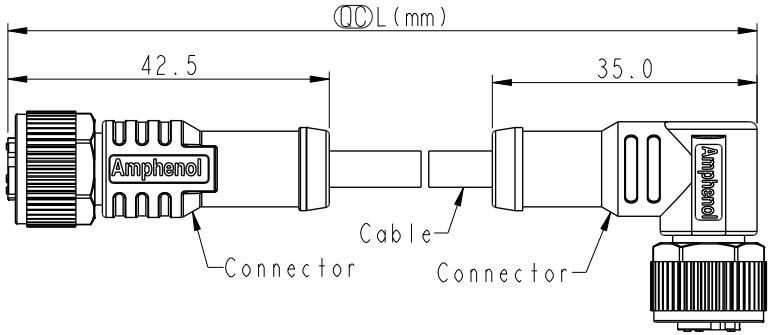
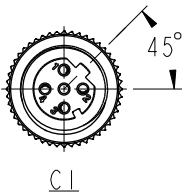

\triangle_B MSDPXXFL-SDPFR-SBXXX

XX: No. Of Pin

XXX: 0.5~99Meters
A05: 0.5 Meter
1: 01 Meter
2: 02 Meters
:
99: 99 Meters

Pin Out	Wire	Color
5	--	--
4	Black	黑
3	Blue	藍
2	White	白
1	Brown	棕

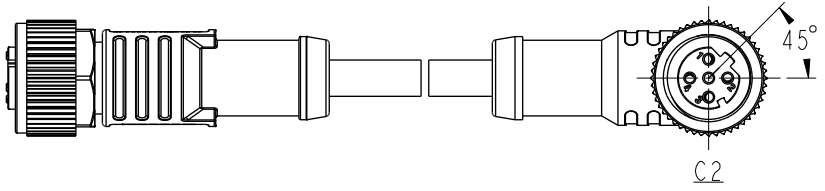

Note: \triangle_B \triangle_C

- * RoHS Compliant
- * \circ Important dimension
- * C1

\triangle_D Waterproof rate: IP68, mated 1m/24h
IP69K, mated
Housing: Thermoplastic, Black
Pin: Copper alloy, Gold plated
O-Ring: Rubber, Green
Nut: Thermoplastic, Black
Outer mold: Thermoplastic, Black

* C2

\triangle_D Waterproof rate: IP68, mated 1m/24h
IP69K, mated
Housing: Thermoplastic, Black
Pin: Copper alloy, Gold plated
O-Ring: Rubber, Green
Nut: Thermoplastic, Black
Outer mold: Thermoplastic, Black

- * Cable: UL20549, 22#*4C, OD=4.0mm, PUR Jacket, Black
- * Cable length tolerance: 0.5M < L ≤ 1M: +60/-0 mm
1M < L ≤ 3M: +120/-0 mm
3M < L ≤ 5M: +160/-0 mm
5M < L ≤ 10M: ±100 mm
10M < L ≤ 20M: ±200 mm
20M < L ≤ 30M: ±300 mm
30M < L ≤ 99M: ±500 mm

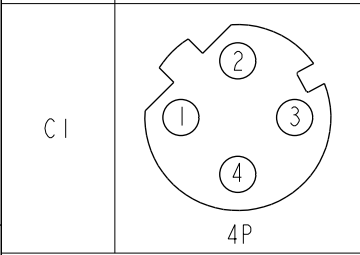
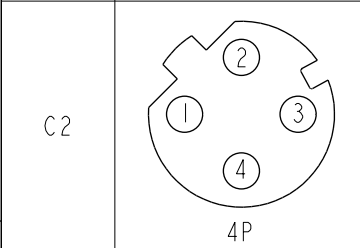

Pin Assignments Front View

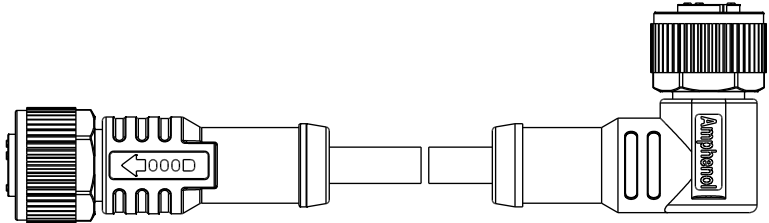

UNIT:mm	\varnothing ∇	TITLE	ACC, SEN, D Code, DB-ENDED FF	
TOLERANCE	± 0.5 mm	SCALE	1:2	SIZE A4
		REV.	D	WC-REV.
			\circ	Inspection item

Amphenol LTW
安費諾亮泰企業股份有限公司

ITEM NO	MSDPXXFL-SDPFR-SBXXX	DWG NO	MSDPXXFL-SDPFR-SBXXX	DRAWN BY	Vicky	DATE	2018-12-12
CUSTOMER	ALTW	CHECKED BY	Rita	DATE	2018-12-12	APPROVED BY	Max
				DATE	2018-12-12		