

THIS DOCUMENT IS SUBJECT TO CHANGE WITHOUT NOTICE. IT IS CONFIDENTIAL AND A PROPERTY OF Amphenol LTW. DISCLOSURE TO THIRD PARTY HAS TO BE AUTHORIZED BY Amphenol LTW.

REV.	ECN NO.	DATE	SIGN	DESCRIPTION
A		2022/05/12	Ruru	Initial Released
B	C230009	2023/01/03	Vicky	\triangle B XI

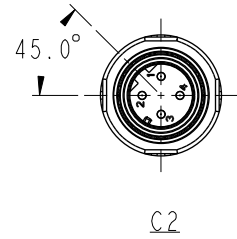
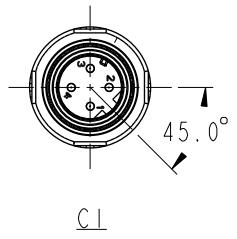
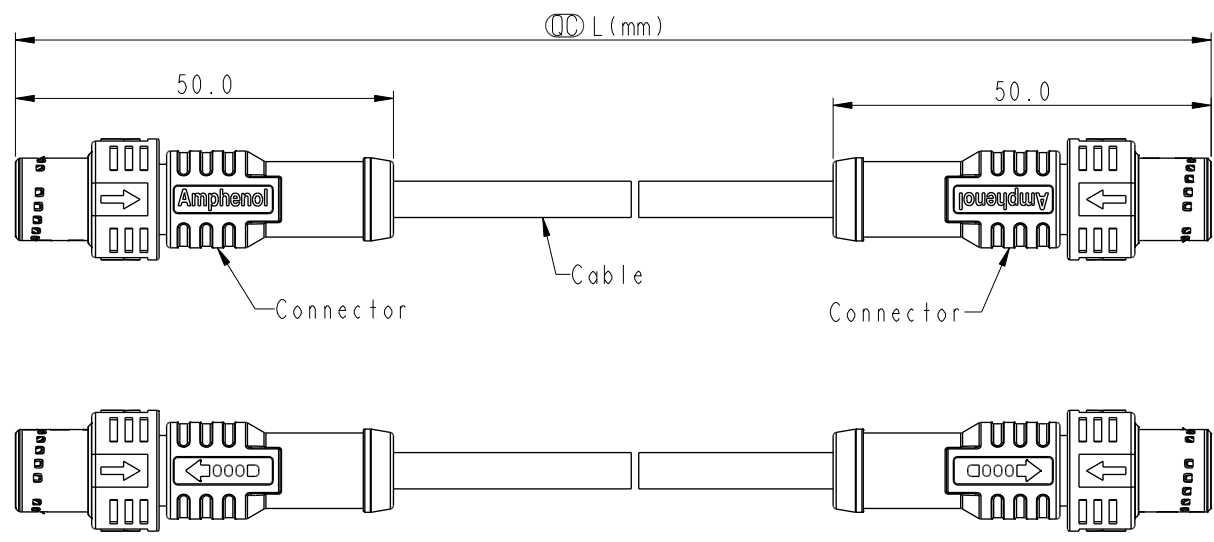

M12DXXML-12DML-PBXXX
 XX: No. Of Pin
 XXX: 0.5~99Meters
 A05: 0.5 Meter
 001: 1 Meter
 002: 2 Meters
 :
 099: 99 Meters

- Note:
- * RoHS Compliant
 - * \varnothing Important dimension
 - \triangle * Waterproof rate: IP68, mated 1m/24h
 - * Connector
 Housing: Thermoplastic, Black
 Pin: Copper alloy, Gold plated
 Shield: Metal
 Slider: Thermoplastic, Black
 Outer Mold: Thermoplastic, Black
 - * Cable: UL20549, 22#*4C, OD=4.0mm, PUR Jacket, Black
 - * Cable Length Tolerance:

0.5M < L ≤ 1M:	+60/-0 mm
1M < L ≤ 3M:	+120/-0 mm
3M < L ≤ 5M:	+160/-0 mm
5M < L ≤ 10M:	±100 mm
10M < L ≤ 20M:	±200 mm
20M < L ≤ 30M:	±300 mm
30M < L ≤ 99M:	±500 mm

Pin Out	5 --	
	4 Black	黑
	3 Blue	藍
	2 White	白
	1 Brown	棕
	Pin #	Wire
C1 & C2		
Pin Assignments Front View		

UNIT:mm TOLERANCE ±0.5mm	TITLE ACC, SEN, D Code, DB-ENDED MM		Amphenol LTW 安費諾亮泰企業股份有限公司		ITEM NO	DRAWN BY Ruru	DATE 2022/05/12
	SCALE 1:1	SIZE A4			SHEET 1	OF 1	DWG NO M12DXXML-12DML-PBXXX
	REV. B	WC-REV. A.1	\varnothing : Inspection item		CUSTOMER ALTW	APPROVED BY Max	DATE 2022/05/12