

THIS DOCUMENT IS SUBJECT TO CHANGE WITHOUT NOTICE. IT IS CONFIDENTIAL AND A PROPERTY OF AMPHENOL LTW. DISCLOSURE TO THIRD PARTY HAS TO BE AUTHORIZED BY AMPHENOL LTW.

REV.	ECN NO.	DATE	SIGN	DESCRIPTION
B	LEN1741191	2017/04/12	Ruru	Change Logo

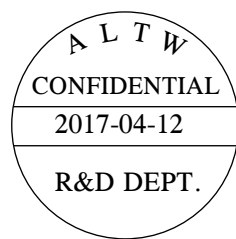

- Note:
- * Important Dimension.
 - * IP Rating: IP67
 - * Housing: Nylon+GF
 - * Pin: Brass, Gold Plated
 - * Liquid Glue: Clear
 - * O-Ring: Black, EPDM
 - * Screw Nut: Black, Nylon+GF
 - * Gasket: Black, Silicone
 - * Clamping Ring: Black, Nylon
 - * Seals: Black, EPDM
 - * PE Bag: 90*85mm
 - * Seals B1 for Cable OD: $\varnothing 7.6\text{mm} \sim \varnothing 9.6\text{mm}$
(防水墊圈B1線徑: $\varnothing 7.6\text{mm} \sim \varnothing 9.6\text{mm}$)
 - * Seals B2 for Cable OD: $\varnothing 4.0\text{mm} \sim \varnothing 7.6\text{mm}$
(防水墊圈B2線徑: $\varnothing 4.0\text{mm} \sim \varnothing 7.6\text{mm}$)
 - * One Set Unassembled in One PE Bag.
(每一組未組裝, 放置於一個PE袋, 並封口)

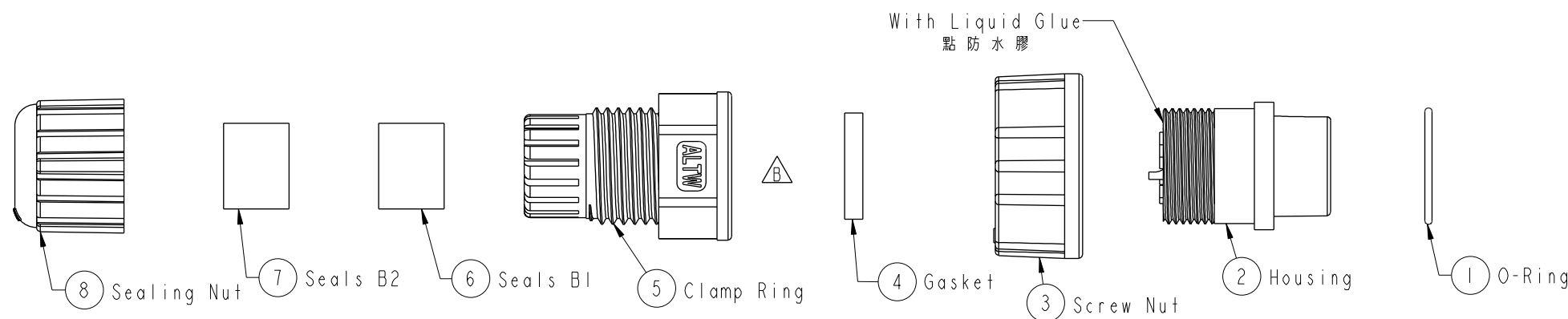
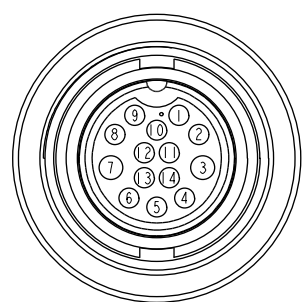
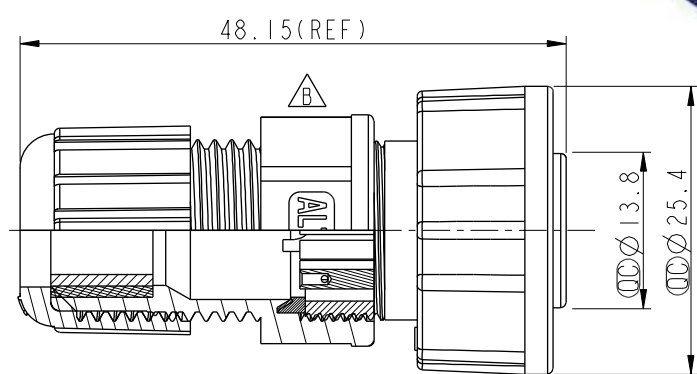

UNIT:mm		TITLE 14Pin Female Connector Male Pin(5A+2A)		Amphenol LTW 安費諾亮泰企業股份有限公司		ITEM NO CDU-14BFMA-SL7001	DRAWN BY Ruru	DATE 2017-04-12
TOLERANCE .X ±0.25 .XX ±0.1 .XXX ±0.05 ANGLES ±1°		SCALE 1:1	SIZE A4	SHEET 1	OF 1	DWG NO CDU-14BFMA-SL7001	CHECKED BY Rita	DATE 2017-04-12
REV. B		WC-REV. A.2	Inspection item		CUSTOMER ALTW		APPROVED BY Max	DATE 2017-04-12