

THIS DOCUMENT IS SUBJECT TO CHANGE WITHOUT NOTICE. IT IS CONFIDENTIAL AND A PROPERTY OF Amphenol LTW. DISCLOSURE TO THIRD PARTY HAS TO BE AUTHORIZED BY Amphenol LTW.

REV.	ECN NO.	DATE	SIGN	DESCRIPTION
B	C231273	2023/10/06	Ruru	$\triangle B$ X5

$\triangle B$
ABB-XXBFFC-LL7XP0

XX: No. Of Pin

- A: With Red&Yellow&Blue Color Seal
- S: With Red Color Seal, Cable OD 5.0~6.0mm.
- M: With Yellow Color Seal, Cable OD 6.0~8.0mm.
- L: With Blue Color Seal, Cable OD 8.0~10.0mm.

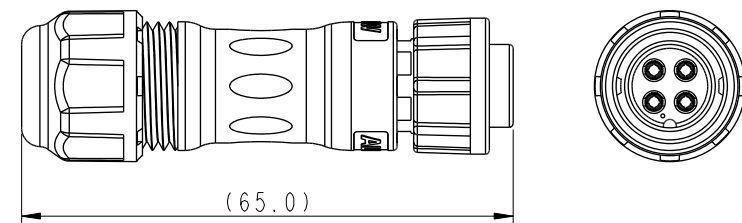
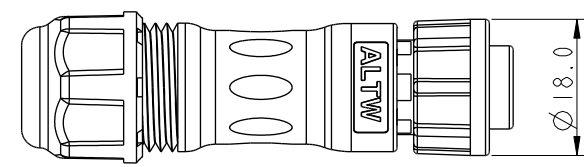
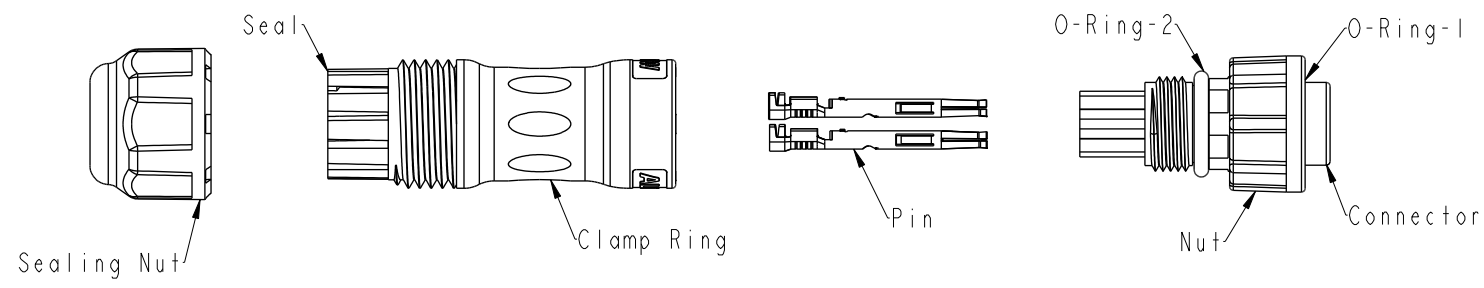

- $\triangle B$ Note:
- * RoHS Compliant
 - * \varnothing Important dimension
 - * Waterproof rate: IP67, mated
 - * Connector
 - Housing: Thermoplastic, Black
 - Pin: Copper alloy, Gold plated
 - Nut: Thermoplastic, Black
 - O-Ring-1: Rubber, Gray
 - O-Ring-2: Rubber, Dark gray
 - * Clamp Ring: Thermoplastic, Black
 - * Sealing Nut: Thermoplastic, Black
 - * Sealing : Rubber
 - * One set unassembled in one pe bag

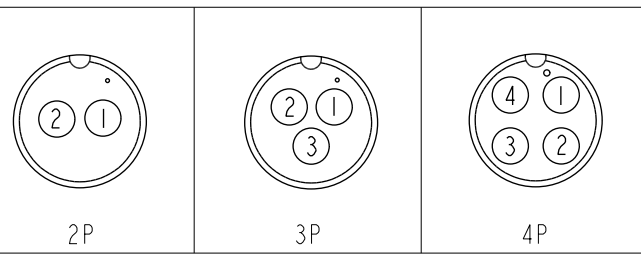

Pin Assignments Front View

UNIT:mm TOLERANCE ± 0.5 mm	TITLE N CERES, ST, B-10A, CABLE W/O SR F, F, CRIMP, 2LOCK		<h1 style="margin: 0;">Amphenol LTW</h1> <p style="margin: 0;">安費諾亮泰企業股份有限公司</p>	ITEM NO	DRAWN BY Peng	DATE 2018-12-15	
	SCALE 8:5	SIZE A4		SHEET 1 OF 1	DWG NO $\triangle B$ ABB-XXBFFC-LL7XP0	CHECKED BY Mafei	DATE 2018-12-15
	REV. B	WC-REV. A.3		\varnothing Inspection item	CUSTOMER ALTW	APPROVED BY Jerry	DATE 2018-12-15