

THIS DOCUMENT IS SUBJECT TO CHANGE WITHOUT NOTICE. IT IS CONFIDENTIAL AND A PROPERTY OF Amphenol LTW. DISCLOSURE TO THIRD PARTY HAS TO BE AUTHORIZED BY Amphenol LTW.

REV.	ECN NO.	DATE	SIGN	DESCRIPTION
B	E191899	2019/11/13	Ruru	X4
C	C231238	2023/09/20	Vicky	X1

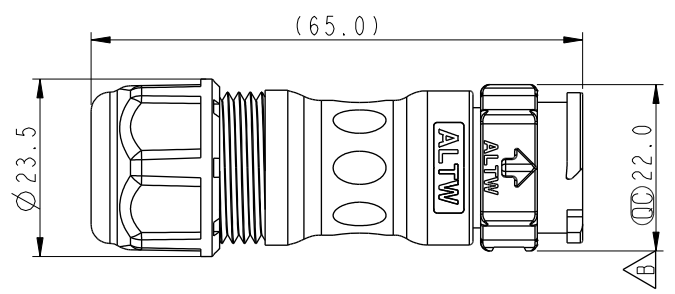
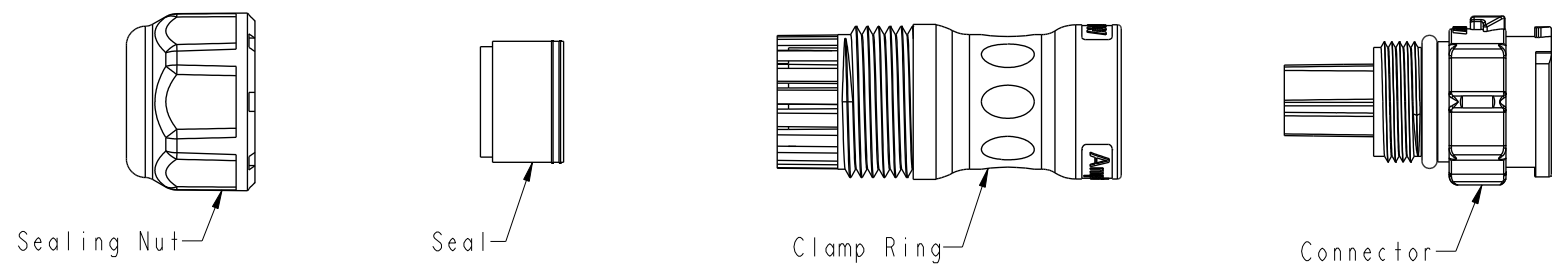

CC-XXBMFA-QL8XPP

02-2 Pin
03-3 Pin

S: With Red Color Seal 1, Cable OD 6.0~8.0mm.
M: With Yellow Color Seal 2, Cable OD 8.0~10.0mm.
L: With Blue Color Seal 3, Cable OD 10.0~12.0mm.
A: With Seal 1 & Seal 2 & Seal 3.

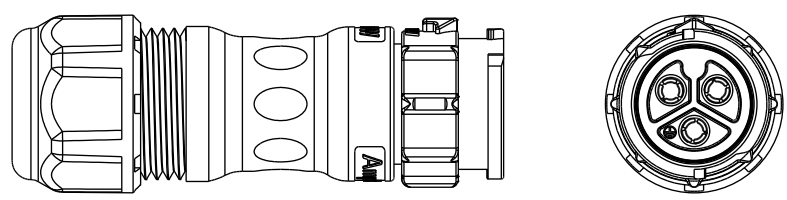

Note:

- * Important Dimension
- * Waterproof Rate: IP68, Mated
IP68 : 1M Depth Of Water In 24hours
- * Housing: Thermoplastic, Black
- * Pin: Copper Alloy, Gold Plated
- * Clamp Ring: Thermoplastic, Black
- * Sealing Nut: Thermoplastic, Black
- * Seals: Rubber
- * One set unassembled in one pe bag

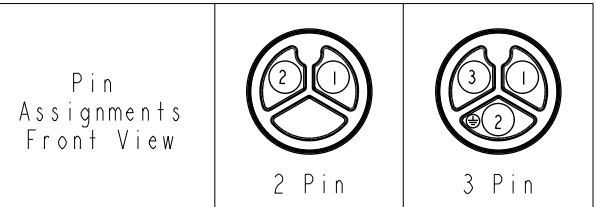

UNIT:mm		TITLE	XLOK, C-20A, CABLE W/O SR M, F, FI CRIMP, XLOK	
TOLERANCE	±0.5 mm	SCALE	1:1	SIZE A4
		REV.	C	WC-REV. A.1
			: Inspection item	

Amphenol LTW
安費諾亮泰企業股份有限公司

ITEM NO	CC-XXBMFA-QL8XPP	DRAWN BY	Ruru	DATE	2019-11-13
DWG NO	ALTW	CHECKED BY	Rita	DATE	2019-11-13
CUSTOMER	ALTW	APPROVED BY	Max	DATE	2019-11-13