

THIS DOCUMENT IS SUBJECT TO CHANGE WITHOUT NOTICE. IT IS CONFIDENTIAL AND A PROPERTY OF AMPHENOL LTW. DISCLOSURE TO THIRD PARTY HAS TO BE AUTHORIZED BY AMPHENOL LTW.

REV.	ECN NO.	DATE	SIGN	DESCRIPTION
A		2016/11/23	Victor Hung	Change Rev.01 To Rev.A
B	C192027	2019/11/21	Vicky	$\triangle B$ X4
C	C231238	2023/09/20	Vicky	$\triangle C$ X1

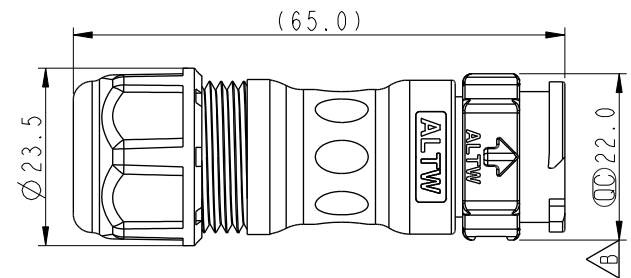
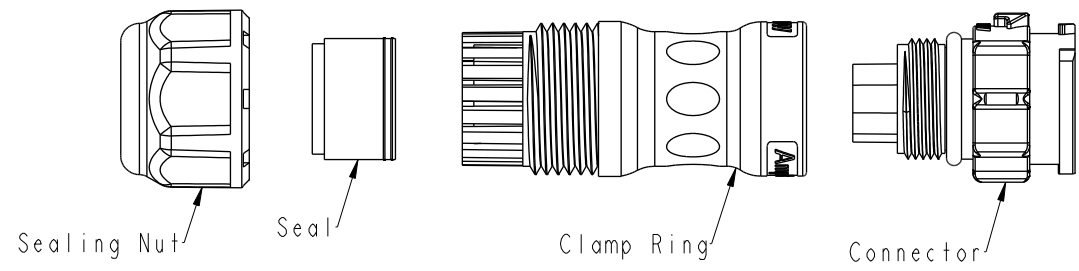

CD-XXBMFA-QL8XP0

07- 7Pin  
08- 8Pin  
09- 9Pin

S: With Red Color Seal 1, Cable OD 6.0~8.0mm.  
M: With Yellow Color Seal 2, Cable OD 8.0~10.0mm.  
L: With Blue Color Seal 3, Cable OD 10.0~12.0mm.  
A: With Seal 1 & Seal 2 & Seal 3.

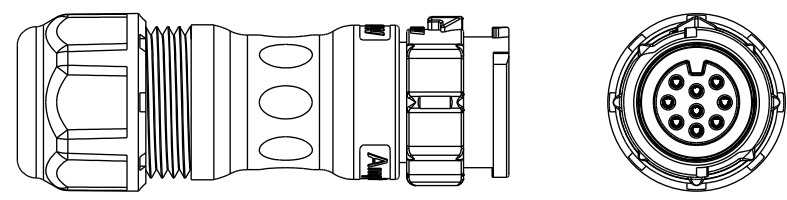

$\triangle B$  Note:

- \*  $\text{CC}$  Important Dimension
- \* Waterproof Rate: IP68, Mated  
IP68: 1M Depth Of Water In 24hours
- \* Housing: Thermoplastic, Black
- \* Pin: Copper Alloy, Gold Plated
- \* Clamp Ring: Thermoplastic, Black
- \* Sealing Nut: Thermoplastic, Black
- \* Seals: Rubber

$\triangle C$  \* One set unassembled in one pe bag

Pin Assignments Front View	7 Pin	8 Pin	9 Pin

UNIT:mm		TITLE	XLOK, C-5A, CABLE W/O SR M, F, FI CRIMP, XLOK	
TOLERANCE	$\pm 0.5\text{mm}$	SCALE	1:1	SIZE A4
		REV.	C	WC-REV. A.5
				$\text{CC}$ : Inspection item

<h1>Amphenol LTW</h1> <p>安費諾亮泰企業股份有限公司</p>		ITEM NO	DRWN BY	DATE
		DWG NO	CHECKED BY	DATE
		CUSTOMER	APPROVED BY	DATE
		ALTW	Kevin Hu	2016-11-23