

THIS DOCUMENT IS SUBJECT TO CHANGE WITHOUT NOTICE. IT IS CONFIDENTIAL AND A PROPERTY OF Amphenol LTW. DISCLOSURE TO THIRD PARTY HAS TO BE AUTHORIZED BY Amphenol LTW.

REV.	ECN NO.	DATE	SIGN	DESCRIPTION
A		2023/04/14	Jiahe Lin	Rev.03 To Rev.A

M8-XXBFFM-SL7CXX  
 XX: No. Of Pin      XX: 01~15Meters  
                           01: 01Meter  
                           02: 02Meters  
                           :                      
                           15: 15Meters

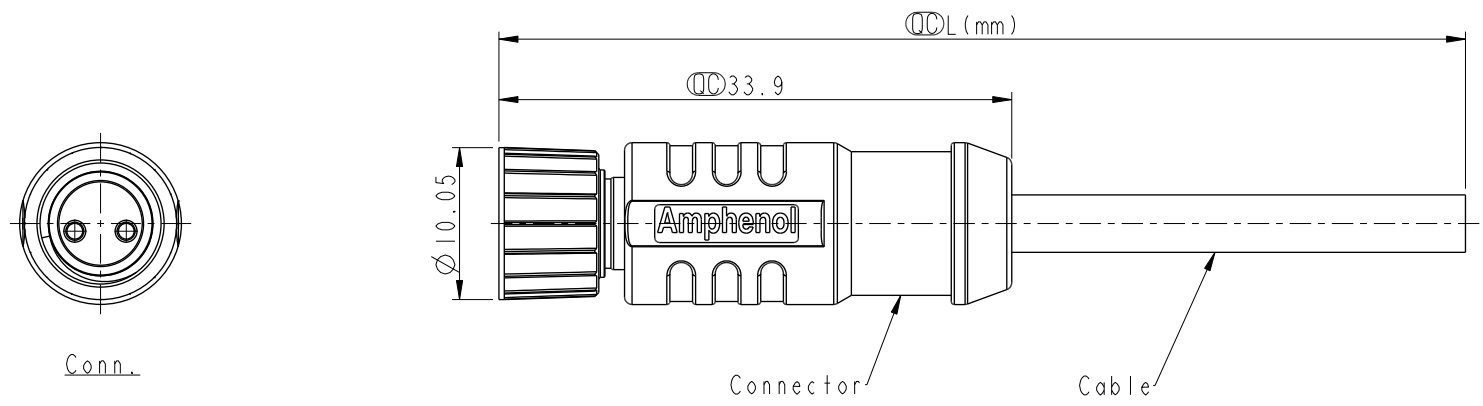

Note:  
 \* RoHS Compliant  
 \*  $\varnothing$  Important dimension  
 \* Waterproof rate: IP67, Mated  
 \* Connector  
   Housing: Thermoplastic, Black  
   Pin: Copper alloy, Gold plated  
   O-ring: Rubber, Gray  
   Nut: Metal  
   Outer mold: Thermoplastic, Black  
 \* Cable: IEC61156-12, 26#\*IP+AL/MY+B,  
   OD=3.8mm, PUR Jacket, Green  
 \* Cable length tolerance: 1M: +50/-0 mm  
                                   1M < L ≤ 3M: +100/-0 mm  
                                   3M < L ≤ 5M: +150/-0 mm  
                                   5M < L ≤ 10M: ±100 mm  
                                   10M < L ≤ 15M: ±200 mm

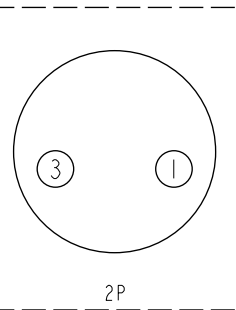

Pin	Wire Color	Pin Out
3	White	白
1	Blue	藍

2P  
 Pin Assignments Front View

UNIT:mm		TITLE	N SEN, M8, SCREW CABLE W/O SR, F, F, MOLDING		
TOLERANCE	±0.5mm	SCALE	1:1	SIZE	A4
		REV.	A	WC-REV.	A.5
				$\varnothing$	Inspection item

**Amphenol LTW**  
 安費諾亮泰企業股份有限公司

ITEM NO	DRAWN BY	DATE
	Jiahe Lin	2023/04/14
DWG NO	CHECKED BY	DATE
M8-XXBFFM-SL7CXX	Neo Tsai	2023/04/14
CUSTOMER	APPROVED BY	DATE
ALTW	Max Yang	2023/04/14