

THIS DOCUMENT IS SUBJECT TO CHANGE WITHOUT NOTICE. IT IS CONFIDENTIAL AND A PROPERTY OF AMPHENOL LTW. DISCLOSURE TO THIRD PARTY HAS TO BE AUTHORIZED BY AMPHENOL LTW.

REV.	ECN NO.	DATE	SIGN	DESCRIPTION
A	Initial Release	2020/12/02	Angel Chou	Rev.02 to A
B	C202000	2020/12/21	Angel Chou	$\triangle B$ X7
C	C231296	2023/10/11	Vicky	$\triangle C$ X1

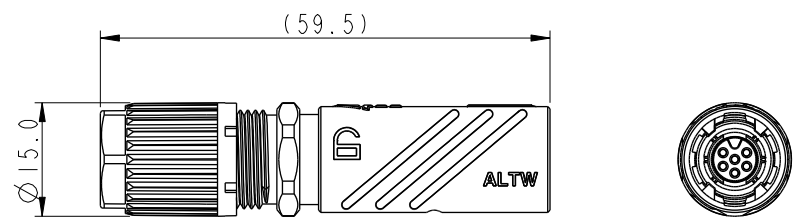
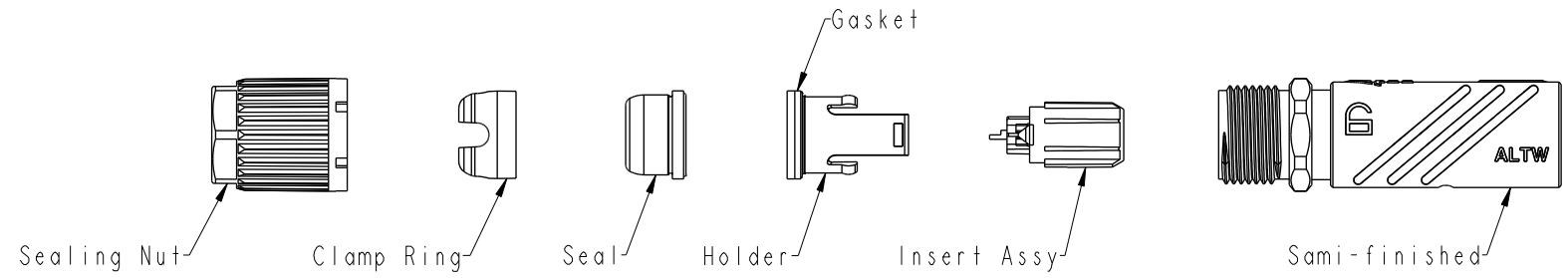

Note:

- * $\text{\textcircled{C}}$ Important Dimension.
- * Waterproof Rate: IP68 (Mating, 1M/24 Hours)
- * Housing: Thermoplastic, Black.
- * Female Pin: Copper Alloy. Gold Plated.
- * Seal: Rubber, Black or Dark Gary.
- * $\triangle B$ Seal Of Cable OD: $\phi 5.5\text{mm} \sim \phi 6.0\text{mm}$
- * Seal Nut: Thermoplastic, Black.
- * Gasket: Rubber, Black or Dark Gary.
- * Clamp Ring: Thermoplastic, Black.
- * Holder: Thermoplastic, Black.
- * Seal Nut Torque: 3.0 ~ 5.0 kgf-cm.
- * $\triangle B$ Rated Voltage: 5 & 6 Pin 100V
- * $\triangle B$ Rated Current: 5 & 6 Pin 2A
- * $\triangle C$ One set unassembled in one pe bag

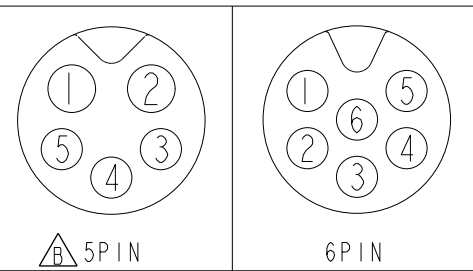

$\triangle B$ Q8U-XXBFFA-QL8001
 U: 2A XX: No. Of Pin

Q8U-05BFFA-QL8001 Q8U-06BFFA-QL8001
 Pin Assignments, Front View

UNIT:mm	$\text{\textcircled{C}}$	TITLE	HS LOK, Q8-2A, CABLE W/O SR F, F, F1 SOLDER, HS LOCK $\triangle B$	
TOLERANCE	$\pm 0.5 \text{ mm}$	SCALE	1:1	SIZE A4
		REV.	C	WC-REV. A.1
				$\text{\textcircled{C}}$: Inspection item

Amphenol LTW
 安費諾亮泰企業股份有限公司

ITEM NO	DRAWN BY	DATE
	Angel Chou	2020/12/02
DWG NO	CHECKED BY	DATE
$\triangle B$ Q8U-XXBFFA-QL8001	Aric Ko	2020/12/02
CUSTOMER	APPROVED BY	DATE
ALTW	Max Yang	2020/12/02