

THIS DOCUMENT IS SUBJECT TO CHANGE WITHOUT NOTICE. IT IS CONFIDENTIAL AND A PROPERTY OF Amphenol LTW. DISCLOSURE TO THIRD PARTY HAS TO BE AUTHORIZED BY Amphenol LTW.

REV.	ECN NO.	DATE	SIGN	DESCRIPTION
A		2023/04/14	Jiahe Lin	Rev.03 To Rev.A

M8-XXBMMM-SL7CXX
 XX: No. Of Pin XX: 01~15Meters
 01: 01Meter
 02: 02Meters
 :
 15: 15Meters

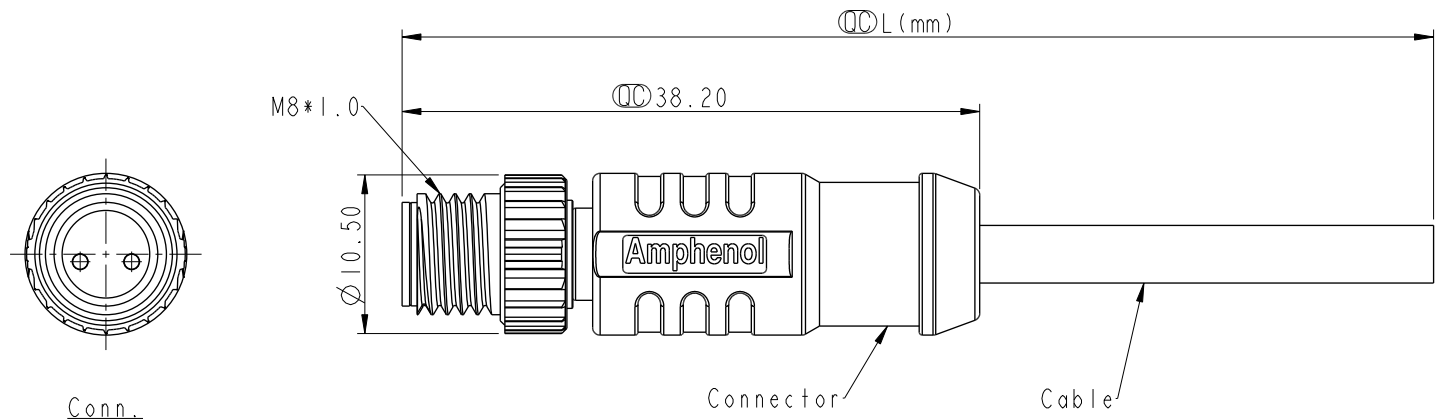

Note:
 * RoHS Compliant
 * \varnothing Important dimension
 * Waterproof rate: IP67, Mated
 * Connector
 Housing: Thermoplastic, Black
 Pin: Copper alloy, Gold plated
 Nut: Metal
 Outer mold: Thermoplastic, Black
 * Cable: IEC61156-12, 26#*1P+AL/MY+B,
 OD=3.8mm, PUR Jacket, Green
 * Cable length tolerance: 1M: +50/-0 mm
 1M < L ≤ 3M: +100/-0 mm
 3M < L ≤ 5M: +150/-0 mm
 5M < L ≤ 10M: ±100 mm
 10M < L ≤ 15M: ±200 mm

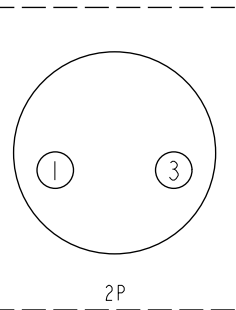

3	White	白
1	Blue	藍
Connector	Wire Color	
Pin Out		

2P
 Pin Assignments Front View

UNIT:mm		TITLE	N SEN, M8, SCREW CABLE W/O SR, M, M, MOLDING		
TOLERANCE	±0.5mm	SCALE	1:1	SIZE	A4
		REV.	A	WC-REV.	A.5
				\varnothing	Inspection item

Amphenol LTW
 安費諾亮泰企業股份有限公司

ITEM NO	DRAWN BY	DATE
	Jiahe Lin	2023/04/14
DWG NO	CHECKED BY	DATE
M8-XXBMMM-SL7CXX	Neo Tsai	2023/04/14
CUSTOMER	APPROVED BY	DATE
ALTW	Max Yang	2023/04/14