

THIS DOCUMENT IS SUBJECT TO CHANGE WITHOUT NOTICE. IT IS CONFIDENTIAL AND A PROPERTY OF AMPHENOL LTW. DISCLOSURE TO THIRD PARTY HAS TO BE AUTHORIZED BY AMPHENOL LTW.

REV.	ECN NO.	DATE	SIGN	DESCRIPTION
C	LEN1670219	2016/07/18	Joyy	Modify The Color Of The Gasket
D	C231273	2023/10/04	Ruru	$\triangle D$ X2
E	C240134	2024/01/25	Ruru	$\triangle E$ X2

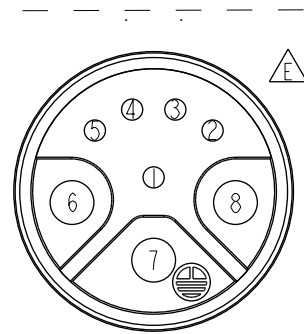

Conn:
Pin Assignments
Front View

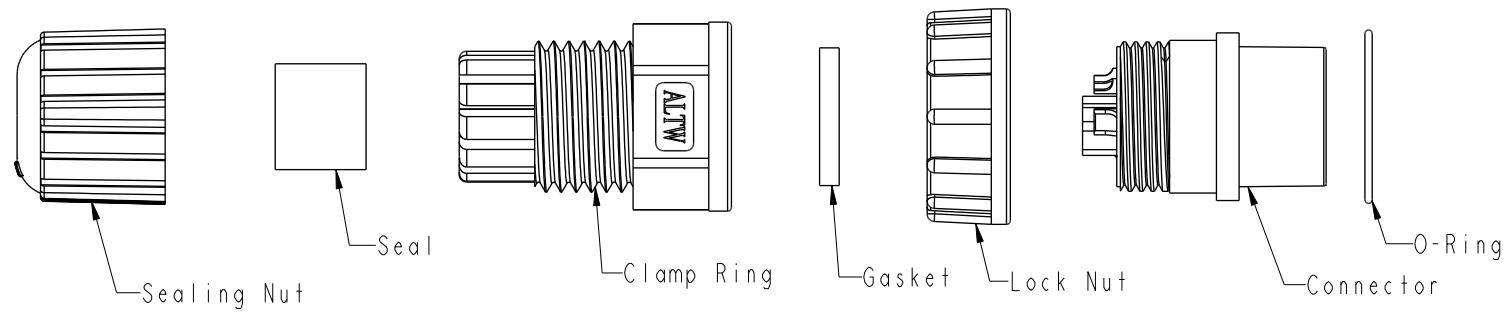
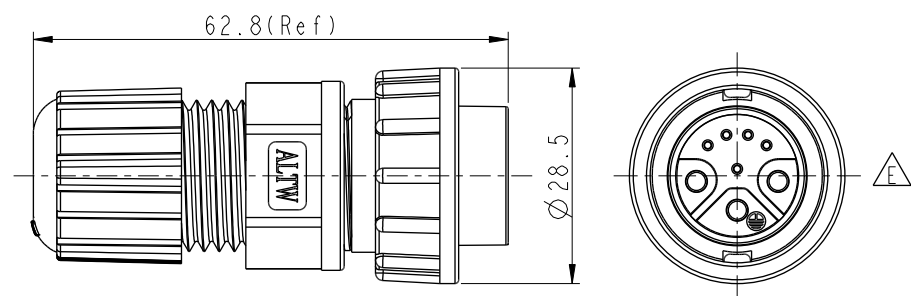

- $\triangle D$ Note:
- * ⌀ Important Dimension To Check
 - * Waterproof Rate: IP67, Mated
 - * Connector: Thermoplastic, Black
 - * Pin: Copper Alloy, Gold Plated
 - * Lock Nut: Thermoplastic, Black
 - * O-Ring: Rubber, Gray
 - $\triangle C$ * Gasket: Rubber, Black
 - * Clamp Ring: Thermoplastic, Black
 - * Seal: Rubber, Gray
 - * Sealing Nut: Thermoplastic, Black
 - $\triangle B$ * Cable OD Max: $\text{⌀}9.5\sim\text{⌀}10.8\text{mm}$
 - * One set unassembled in one pe bag

UNIT:mm		
TOLERANCE		
.X	± 0.25	
.XX	± 0.1	
.XXX	± 0.05	
ANGLES	$\pm 1^\circ$	

TITLE O CERES, D-20A+2A, 08P, CABLE W/O SR F, M PWR+F SIG, FI SOLDER, 2LOCK $\triangle D$			
SCALE	SIZE	SHEET	OF
1:1	A4	1	1
REV.	WC-REV.	⌀ : Inspection item	
E	B.3		

Amphenol LTW
安費諾亮泰企業股份有限公司

ITEM NO	DCU-08BFEA-LL7001	DRAWN BY	Ruru	DATE	2024-01-25
DWG NO	DCU-08BFEA-LL7001	CHECKED BY	Rita	DATE	2024-01-25
CUSTOMER	ALTW	APPROVED BY	Fred	DATE	2024-01-25